



Agency of Transportation

State of Vermont
Policy, Planning & Intermodal Development Division
Policy, Planning and Research Bureau
Development Review & Permitting Services Section
Barre City Place, 219 North Main Street
Barre, VT 05641
vtrans.vermont.gov

[phone] 802-636-0037
[ttd] 800-253-0191

January 2, 2020

Town of Bennington
Daniel Monks
205 South Street, PO Box 469
Bennington, VT 05201
[Via E-Mail]

Subject: Bennington, US7, L.S. 219+50 ~ 224+20 LT & RT and
Bennington, VT7A, L.S. 0+00 ~ 6+65 RT

**Bennington STP SDWK(12) and Bennington STP BP18(14) – Kocher Drive Sidewalk
VTrans Permit ID 41664 – Permit Extension and Revision**

Dear Mr. Monks:

Per your request, the "work completion date" for the permit issued on December 19, 2018, to construct a shared use path along VT7A and Kocher Drive, including a new crosswalk over Aldi/CVS Drive and US7, **has been extended to December 1, 2020**. Work under this permit also includes drainage, roadway improvements and modifications to VTrans signal system.

This permit extension acknowledges and approves revisions to the project plans, dated "Final Plans For Construction November 2019", which includes the elimination of all street trees and shrubs within the VT7A state right-of-way and the replacement of the box culvert extension with a prefabricated pedestrian bridge located within the Town's highway right-of-way.

This permit extension letter becomes a part of the originally issued permit and should be attached to your copy.

The work must be completed under the same conditions as set forth in the original permit #41664.

Please feel free to contact Theresa Gilman at (802) 917-4496 if you have questions or comments

Sincerely,

E-SIGNED by Craig Keller
on 2020-01-03 12:10:19 GMT

Craig S. Keller, P.E.
Chief of Permitting Services
Permitting Services Section

Attachment

cc: [Via E-Mail]
Nick Myran, MSK Engineering, Inc
Mark Anders, Bennington Regional Planning Commission
District Transportation Office #1 (Rob Faley, Chris Taft)
Tina Bohl, Project Manager, VTrans Municipal Assistance Bureau
Ian Degutis, VTrans Transportation Operation Engineer, TSMO
Derek Lyman, VTrans Traffic Signal Operations Engineer, TSMO
Joe Kelly, VTrans Traffic Safety Investigator, TSMO
Nancy Avery, VTrans Work Zone Engineer, TSMO

STATE OF VERMONT AGENCY OF TRANSPORTATION



BENNINGTON - STP SDWK(12) & BP18(14) TOWN OF BENNINGTON COUNTY OF BENNINGTON

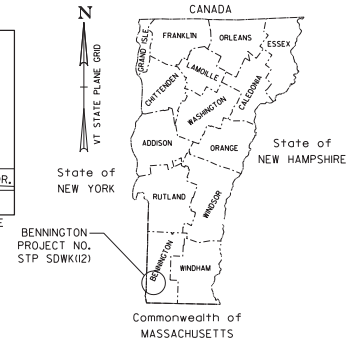
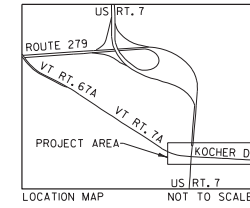

PROJECT LOCATION

BEGINNING ON KOCHER DRIVE AT THE INTERSECTION WITH NORTHSIDE DRIVE AND PROCEEDING EASTERLY ALONG KOCHER DRIVE FOR 0.3 MILES TO THE INTERSECTION WITH PERFORMANCE DRIVE.

PROJECT LENGTH: APPROXIMATELY 1600 FEET

PROJECT DESCRIPTION

CONSTRUCTION OF A SHARED USE PATH ALONG KOCHER DRIVE INCLUDING A PREFABRICATED PEDESTRIAN BRIDGE, SIGNAL, DRAINAGE & ROADWAY IMPROVEMENTS.

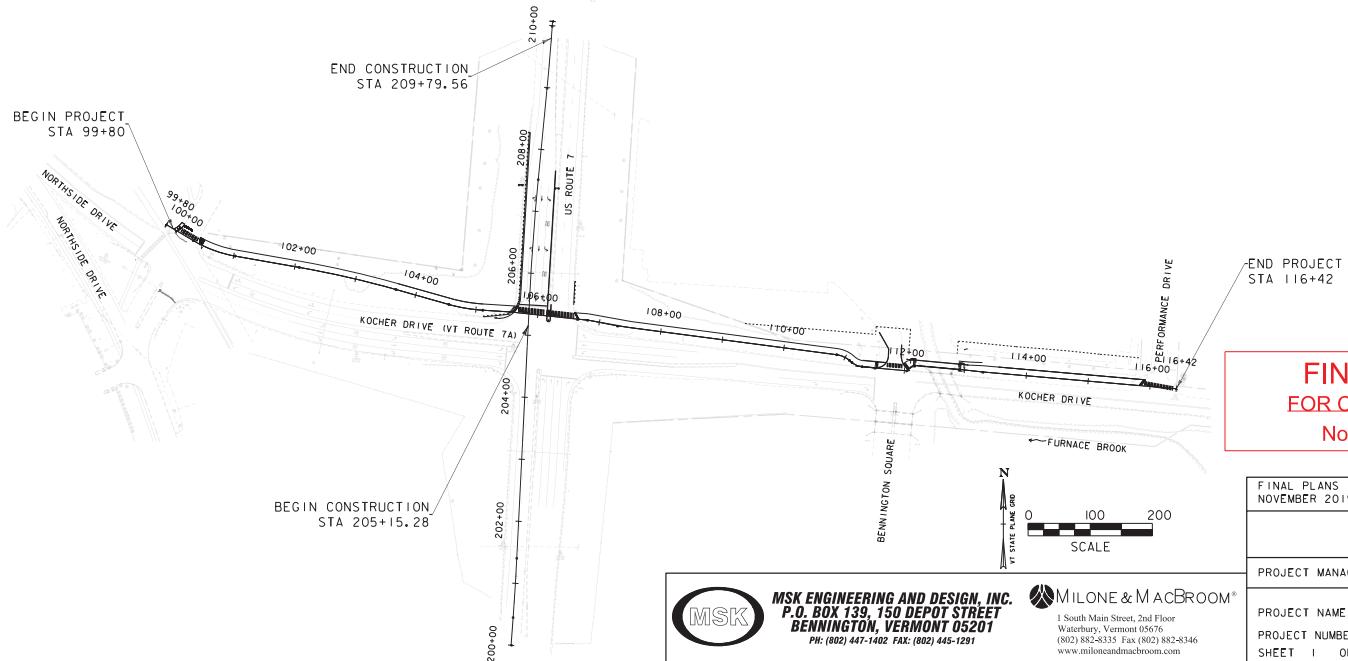

**FINAL PLANS
FOR CONSTRUCTION
November 2019**

CONSTRUCTION IS TO BE CARRIED ON IN ACCORDANCE WITH THESE PLANS AND THE 2018 VERMONT AGENCY OF TRANSPORTATION STANDARD SPECIFICATIONS FOR CONSTRUCTION DATED APRIL 13, 2018, INCLUDING ALL SUBSEQUENT REVISIONS AND SUCH REVISED SPECIFICATIONS AND SPECIAL PROVISIONS AS ARE INCORPORATED IN THESE PLANS.

QUALITY ASSURANCE PROGRAM : LEVEL 2
SURVEYED BY : MSK ENGINEERING, INC. SURVEYED DATE : NOVEMBER 2014
DATUM VERTICAL: NAVD 1988 HORIZONTAL: NAD 1983

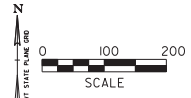

MSK ENGINEERING AND DESIGN, INC.
P.O. BOX 139, 150 DEPOT STREET
BENNINGTON, VERMONT 05201
PH: (802) 447-1402 FAX: (802) 445-1291

MILONE & MACBROOM
1 South Main Street, 2nd Floor
Waterbury, Vermont 05676
(802) 882-8335 Fax (802) 882-8346
www.miloneandmacbroom.com

FINAL PLANS NOVEMBER 2019
PROJECT MANAGER : JASON DOLNETSCH
PROJECT NAME : KOCHER DRIVE PROJECT NUMBER : STP SDWK (12) & STP BP18 (14) SHEET 1 OF 29 SHEETS

INDEX OF SHEETS		TOTAL NUMBER OF SHEETS
SHEET #	TITLE	
1	TITLE SHEET	
2	INDEX OF SHEETS	
3	LEGEND	
4-5	TYPICAL DETAILS	
6-8	QUANTITY SHEETS	
9	ALIGNMENT LAYOUT SHEET	
10-12	SIDEWALK LAYOUT SHEETS	
13	SIDEWALK PROFILE	
14	PAVEMENT MARKING DETAIL	
15-19	CROSS SECTIONS	
20	CONSTRUCTION APPROACH SIGNING AND TRAFFIC CONTROL NOTES	
21-22	TRAFFIC SIGNAL PLANS	
23	DRAINAGE PROFILES	
24-26	BRIDGE PLANS & DETAILS	
27-29	RIGHT-OF-WAY ACQUISITIONS	

VTRANS STANDARDS		
SHEET #	TITLE	DATE
B-5	SLOPE GRADING, EMBANKMENTS, MUCK	06-01-1994
C-3A	SIDEWALK RAMPS	03-10-2008
C-3B	SIDEWALK RAMPS AND MEDIAN ISLANDS	03-10-2008
C-10	CURBING	02-11-2008
D-16	DRAINAGE DETAILS INCLUDING DROP INLETS, IRON GRATE TYPE B&C, CONCRETE END SECTIONS, ETC.	06-01-1994
D-20	HIGHWAY CROSSING SLEEVES FOR UNDERGROUND UTILITIES	03-03-2003
E-12I	STANDARD SIGN PLACEMENT CONVENTIONAL ROAD	08-09-1995
E-145B	REGULATORY SIGN DETAILS - LANE USE CONTROL SIGNS	12-23-1994
E-170	TRAFFIC CONTROL SIGNALS PEDESTAL POST MOUNTED	11-04-1999
E-171a	TRAFFIC CONTROL SIGNALS GENERAL NOTES & DETAILS	08-09-1995
E-171b	TRAFFIC CONTROL SIGNALS MISC. DETAILS	08-09-1995
E-171c	TRAFFIC CONTROL SIGNALS CANTILEVER MOUNTING DETAILS	08-09-1995
E-173	PULL BOXES AND JUNCTION BOXES	08-09-1995
G-1	STEEL BEAM GUARDRAIL WITH STEEL POSTS	11-10-2015
G-1D	STEEL BEAM GUARDRAIL DETAILS (END TERMINAL, ANCHOR, MEDIAN)	03-10-2017
S-364C	GUARDRAIL APPROACH SECTION, GALVANIZED 3 RAIL BOX BEAM	02-10-2014
T-1	TRAFFIC CONTROL GENERAL NOTES	04-25-2016
T-10	CONVENTIONAL ROADS CONSTRUCTION APPROACH SIGNING	08-06-2012
T-28	CONSTRUCTION SIGN DETAILS	08-06-2012
T-29	CONSTRUCTION SIGN DETAILS	08-06-2012
T-30	CONSTRUCTION SIGN DETAILS	08-06-2012
T-31	CONSTRUCTION SIGN DETAILS	08-06-2012
T-45	SQUARE TUBE SIGN POST AND ANCHOR	01-02-2013
T-55	SIGN PLACEMENT EXPRESSWAY & FREEWAY	10-26-2015
T-56	STANDARD SIGN PLACEMENT	10-26-2015

PROJECT NAME:	KOCHER DRIVE
PROJECT NUMBER:	STP SDWK (12) & STP BP18 (14)
FILE NAME:	zSTPSDWK12-Index
PROJECT LEADER:	J. DOLMETSCH
DESIGNED BY:	J. DOLMETSCH
INDEX OF SHEETS	
PLOT DATE:	10/1/2019
DRAWN BY:	N. YOSKOWITZ
CHECKED BY:	J. DOLMETSCH
SHEET	2 OF 29

GENERAL INFORMATION

SYMBOLGY LEGEND NOTE

THE SYMBOLGY ON THIS SHEET IS INTENDED TO COVER STANDARD CONVENTIONAL SYMBOLGY. THE SYMBOLGY IS USED FOR EXISTING & PROPOSED FEATURES WITH HEAVIER LINEWEIGHT, IN COMBINATION WITH PROJECT ANNOTATION, AS NOTED ON PROJECT PLAN SHEETS. THIS LEGEND SHEET COVERS THE BASICS. SYMBOLGY ON PLANS MAY VARY, PLAN ANNOTATIONS AND NOTES SHOULD BE USED TO CLARIFY AS NEEDED.

R. O. W. ABBREVIATIONS (CODES) & SYMBOLS

POINT CODE	DESCRIPTION
CH	CHANNEL EASEMENT
CONST	CONSTRUCTION EASEMENT
CUL	CULVERT EASEMENT
D&C	DISCONNECT & CONNECT
DIT	DITCH EASEMENT
DR	DRAINAGE EASEMENT
DRIVE	DRIVEWAY EASEMENT
EC	EROSION CONTROL
HWY	HIGHWAY EASEMENT
I&M	INSTALL & MAINTAIN EASEMENT
LAND	LANDSCAPE EASEMENT
R&RES	REMOVE & RESET
R&REP	REMOVE & REPLACE
SR	SLOPE RIGHT
UE	UTILITY EASEMENT
(P)	PERMANENT EASEMENT
(T)	TEMPORARY EASEMENT
■	BNDNS BOUND SET
□	BNDNS BOUND TO BE SET
●	IPNS IRON PIN SET
⊙	IPNS IRON PIN TO BE SET
⊗	CALC EXISTING ROW POINT
○	PROW PROPOSED ROW POINT
[LENGTH]	LENGTH CARRIED ON NEXT SHEET

COMMON TOPOGRAPHIC POINT SYMBOLS

POINT CODE	DESCRIPTION
#	APL BOUND APPARENT LOCATION
•	BM BENCHMARK
•	BD BOUND
□	CB CATCH BASIN
⊙	COMB COMBINATION POLE
□	DITHR DROP INLET THROATED DNC
⊙	EL ELECTRIC POWER POLE
•	FPOLE FLAGPOLE
⊙	GASFIL GAS FILLER
⊙	GP GUIDE POST
•	GSO GAS SHUT OFF
•	GUY GUY POLE
•	GUYW GUY WIRE
•	GV GATE VALVE
⊙	H TREE HARDWOOD
△	HCTRL CONTROL HORIZONTAL
△	HVCTRL CONTROL HORIZ. & VERTICAL
⊙	HYD HYDRANT
•	IP IRON PIN
•	IPIPE IRON PIPE
□	LI LIGHT - STREET OR YARD
□	MB MAILBOX
⊙	MH MANHOLE (MH)
•	MM MILE MARKER
•	PM PARKING METER
•	PMK PROJECT MARKER
•	POST POST STONE/WOOD
•	RRSIG RAILROAD SIGNAL
•	RRSL RAILROAD SWITCH LEVER
•	S TREE SOFTWOOD
+	SAT SATELLITE DISH
⊙	SHRUB SHRUB
+	SIGN SIGN
+	STUMP STUMP
⊙	TEL TELEPHONE POLE
⊙	TIE TIE
⊙	TSIGN SIGN W/DOUBLE POST
⊙	VCTRL CONTROL VERTICAL
•	WELL WELL
•	WSO WATER SHUT OFF

THESE ARE COMMON VAOT SURVEY POINT SYMBOLS FOR EXISTING FEATURES, ALSO USED FOR PROPOSED FEATURES WITH HEAVIER LINEWEIGHT, IN COMBINATION WITH PROPOSED ANNOTATION.

PROPOSED GEOMETRY CODES

CODE	DESCRIPTION
PC	POINT OF CURVATURE
PI	POINT OF INTERSECTION
CC	CENTER OF CURVE
PT	POINT OF TANGENCY
PCC	POINT OF COMPOUND CURVE
PRC	POINT OF REVERSE CURVE
POB	POINT OF BEGINNING
POE	POINT OF ENDING
STA	STATION PREFIX
AH	AHEAD STATION SUFFIX
BK	BACK STATION SUFFIX
D	CURVE DEGREE OF (100FT)
R	CURVE RADIUS OF
T	CURVE TANGENT LENGTH
L	CURVE LENGTH OF
E	CURVE EXTERNAL DISTANCE

UTILITY SYMBOLGY

UNDERGROUND UTILITIES

— UGU —	UTILITY (GENERIC-UNKNOWN)
— UT —	TELEPHONE
— UE —	ELECTRIC
— UC —	CABLE (TV)
— UEC —	ELECTRIC+CABLE
— UET —	ELECTRIC+TELEPHONE
— UCT —	CABLE+TELEPHONE
— UECT —	ELECTRIC+CABLE+TELEP.
— G —	GAS LINE
— W —	WATER LINE
— S —	SANITARY SEWER (SEPTIC)

ABOVE GROUND UTILITIES (AERIAL)

— AGU —	UTILITY (GENERIC-UNKNOWN)
— T —	TELEPHONE
— E —	ELECTRIC
— C —	CABLE (TV)
— EC —	ELECTRIC+CABLE
— ET —	ELECTRIC+TELEPHONE
— AER E&T —	ELECTRIC+TELEPHONE
— CT —	CABLE+TELEPHONE
— ECT —	ELECTRIC+CABLE+TELEP.
—	UTILITY POLE GUY WIRE

PROJECT CONSTRUCTION SYMBOLGY

PROJECT DESIGN & LAYOUT SYMBOLGY

— — — CZ — — —	CLEAR ZONE
— — — — —	PLAN LAYOUT MATCHLINE

PROJECT CONSTRUCTION FEATURES

△ — △ — △ — △ — △ —	TOP OF CUT SLOPE
○ — ○ — ○ — ○ — ○ —	TOE OF FILL SLOPE
⊗ — ⊗ — ⊗ — ⊗ — ⊗ —	STONE FILL
⊙ — ⊙ — ⊙ — ⊙ — ⊙ —	BOTTOM OF DITCH
— — — — —	CULVERT PROPOSED
— — — — —	STRUCTURE SUBSURFACE
PDF — — — — —	PROJECT DEMARCATION FENCE
BF — — — — —	BARRIER FENCE
XXXXXXXXXXXXXXXXXXXX	TREE PROTECTION ZONE (TPZ)
//////	STRIPING LINE REMOVAL
~~~~~	SHEET PILES

**CONVENTIONAL BOUNDARY SYMBOLGY**

**BOUNDARY LINES**

— — — — —	TOWN BOUNDARY LINE
— — — — —	COUNTY BOUNDARY LINE
— — — — —	STATE BOUNDARY LINE
— — — — —	PROPOSED STATE R.O.W. (LIMITED ACCESS)
— — — — —	PROPOSED STATE R.O.W.
— — — — —	STATE ROW (LIMITED ACCESS)
— — — — —	STATE ROW
— — — — —	TOWN ROW
— — — — —	PERMANENT EASEMENT LINE (P)
— — — — —	TEMPORARY EASEMENT LINE (T)
— — — — —	SURVEY LINE
— — — — —	PROPERTY LINE (P/L)
SR — — — — —	SLOPE RIGHTS
6f — — — — —	6F PROPERTY BOUNDARY
4f — — — — —	4F PROPERTY BOUNDARY
HAZ — — — — —	HAZARDOUS WASTE

**EPSC LAYOUT PLAN SYMBOLGY**

**EPSC MEASURES**

○ — ○ — ○ — ○ — ○ —	FILTER CURTAIN
— — — — —	SILT FENCE
⊗ — ⊗ — ⊗ — ⊗ — ⊗ —	SILT FENCE WOVEN WIRE
— — — — —	CHECK DAM
■	DISTURBED AREAS REQUIRING RE-VEGETATION
⊗	EROSION MATTING

SEE EPSC DETAIL SHEETS FOR ADDITIONAL SYMBOLGY

**ENVIRONMENTAL RESOURCES**

— — — — —	WETLAND BOUNDARY
— — — — —	RIPARIAN BUFFER ZONE
— — — — —	WETLAND BUFFER ZONE
— — — — —	SOIL TYPE BOUNDARY
— — — — —	THREATENED & ENDANGERED SPECIES
HAZ — — — — —	HAZARDOUS WASTE AREA
AG — — — — —	AGRICULTURAL LAND
HABITAT — — — — —	FISH & WILDLIFE HABITAT
FLOOD PLAIN — — — — —	FLOOD PLAIN
OH — — — — —	ORDINARY HIGH WATER (OHW)
— — — — —	STORM WATER
— — — — —	USDA FOREST SERVICE LANDS
— — — — —	WILDLIFE HABITAT SUIT/CONN

**ARCHEOLOGICAL & HISTORIC**

— — — — —	ARCHEOLOGICAL BOUNDARY
— — — — —	HISTORIC DISTRICT BOUNDARY
— — — — —	HISTORIC AREA
(H)	HISTORIC STRUCTURE

**CONVENTIONAL TOPOGRAPHIC SYMBOLGY**

**EXISTING FEATURES**

— — — — —	ROAD EDGE PAVEMENT
— — — — —	ROAD EDGE GRAVEL
— — — — —	DRIVEWAY EDGE
— — — — —	DITCH
— — — — —	FOUNDATION
x — x — x — x — x —	FENCE (EXISTING)
□ — □ — □ — □ — □ —	FENCE WOOD POST
○ — ○ — ○ — ○ — ○ —	FENCE STEEL POST
— — — — —	GARDEN
— — — — —	ROAD GUARDRAIL
	RAILROAD TRACKS
— — — — —	CULVERT (EXISTING)
— — — — —	STONE WALL
— — — — —	WALL
— — — — —	WOOD LINE
— — — — —	BRUSH LINE
— — — — —	HEDGE
— — — — —	BODY OF WATER EDGE
— — — — —	LEDGE EXPOSED

PROJECT NAME: KOCHER DRIVE  
 PROJECT NUMBER: STP SDWK (I2) & STP BP18 (I4)  
 FILE NAME: zSTPsdwk12.legend  
 PROJECT LEADER: J. DOLMETSCH  
 DESIGNED BY: J. DOLMETSCH  
 LEGEND  
 PLOT DATE: 10/11/2019  
 DRAWN BY: N. YOSKOWITZ  
 CHECKED BY: J. DOLMETSCH  
 SHEET 3 OF 29

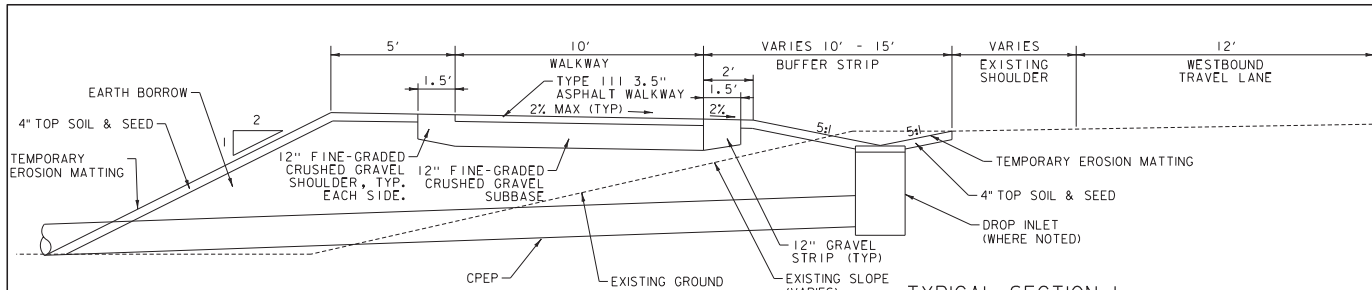

**TYPICAL SECTION 1**  
**KOCHER DRIVE (US7 TO PERFORMANCE DRIVE)**  
 NOT TO SCALE

**SEEDING**

1. THE SEED MIXTURE SHALL NOT HAVE A WEED CONTENT EXCEEDING 0.4% BY WEIGHT AND SHALL BE FREE OF ALL NOXIOUS WEED SEED.
  2. USE THE FOLLOWING SEED MIXTURE:
- | 2#   | LBS./ACRE | NAME                | PLRZ | GERMZ |
|------|-----------|---------------------|------|-------|
| 42.5 | 34.0      | CREeping RED FESCUE | 98   | 85    |
| 20.0 | 16.0      | PERENNIAL RYE GRASS | 95   | 90    |
| 32.5 | 26.0      | KENTUCKY BLUE GRASS | 85   | 85    |
| 5.0  | 4.0       | ANNUAL RYE GRASS    | 95   | 85    |
3. MULCHING PER VTRANS STANDARD SPECIFICATION 653.07

- GENERAL CONSTRUCTION NOTES**
1. CONTRACTOR SHALL CONTACT DIG SAFE AND TOWN OF BENNINGTON AT LEAST 72 HOURS PRIOR TO ANY SUBGRADE CONSTRUCTION AND MUST RECEIVE AN AUTHORIZATION NUMBER.
  2. LOCATIONS OF UNDERGROUND UTILITIES ARE NOT BASED ON DIG SAFE MARKINGS AND ARE NOT WARRANTED TO BE EXACT OR COMPLETE. THE CONTRACTOR SHALL VERIFY THE EXACT LOCATIONS OF EXISTING UTILITIES AND SHALL BE RESPONSIBLE FOR ANY DAMAGE TO ANY UTILITY, PUBLIC OR PRIVATE.
  3. THE CONSTRUCTION INSPECTOR SHALL MAINTAIN AS-BUILT PLANS WITH TIES AND ELEVATIONS FOR ALL UNDERGROUND UTILITIES. AS-BUILT PLANS SHALL BE SUBMITTED TO THE TOWN OF BENNINGTON AT THE COMPLETION OF THE PROJECT.
  4. THE CONTRACTOR SHALL BE RESPONSIBLE FOR ALL WORK NECESSARY FOR COMPLETE AND OPERABLE FACILITIES AND UTILITIES.
  5. THESE PLANS ARE NOT INTENDED TO BE A BOUNDARY SURVEY. THE PROPERTY LINES ARE BASED ON FIELD WORK AND TAX MAPS FROM THE TOWN OF BENNINGTON.
  6. THE CONTRACTOR SHALL BE RESPONSIBLE FOR DEMOLITION AND REMOVAL OF STRUCTURES, VEGETATION, AND PAVEMENT NECESSARY TO CONSTRUCT THE PROJECT, UNLESS OTHERWISE NOTED ON THE PLANS. THE CONTRACTOR SHALL REMOVE ALL EXCESS MATERIAL, DEBRIS, AND TRASH FROM THE SITE UPON COMPLETION OF CONSTRUCTION, UNLESS OTHERWISE DIRECTED BY THE TOWN.
  7. ANY DE-WATERING THAT IS NECESSARY FOR THE COMPLETION OF THE SITE WORK SHALL BE CONSIDERED AS PART OF THE CONTRACT AND SHALL BE THE CONTRACTOR'S RESPONSIBILITY.
  8. ANY CONFLICTS OR INCONSISTENCIES WITH THE PLANS OR SPECIFICATIONS SHALL BE BROUGHT TO THE IMMEDIATE ATTENTION OF THE ENGINEER.
  9. THE CONTRACTOR SHALL CONFORM TO ALL PERMITS AND EASEMENTS ASSOCIATED WITH THE CONSTRUCTION OF THIS PROJECT, IN PARTICULAR, TEMPORARY CONSTRUCTION EASEMENTS FOR PRIVATE PROPERTIES.
  10. DETECTABLE WARNING SURFACE, PAY ITEM 618.30 SHALL BE CAST IRON WHERE NEW RAMPS ARE CONSTRUCTED.

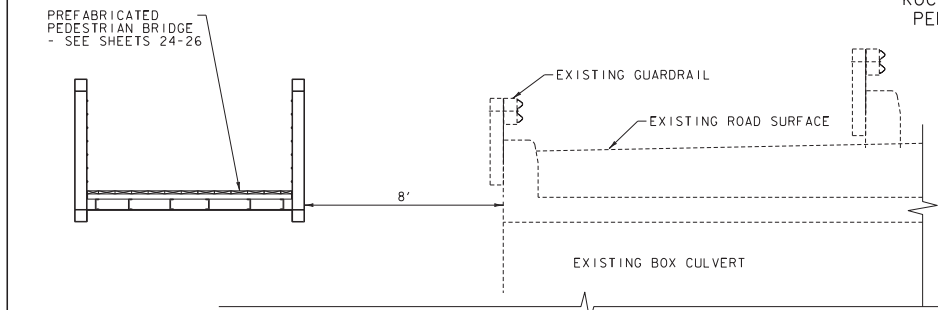

**TYPICAL SECTION 2**  
**KOCHER DRIVE - BRIDGE OVER FURNACE BROOK**  
 NOT TO SCALE

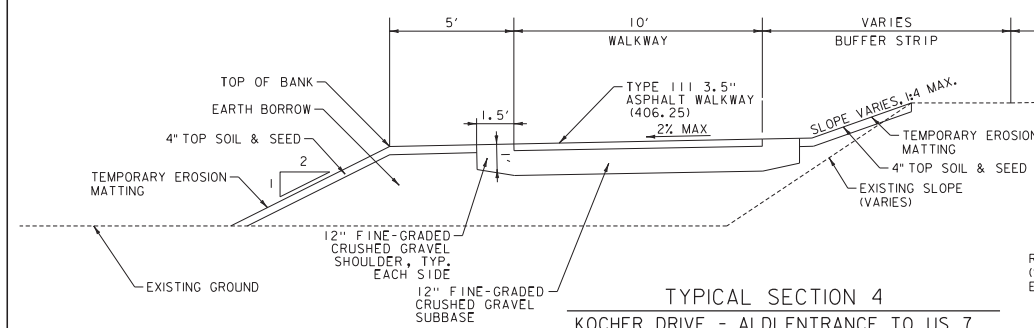

**TYPICAL SECTION 4**  
**KOCHER DRIVE - ALDI ENTRANCE TO US 7**  
 NOT TO SCALE

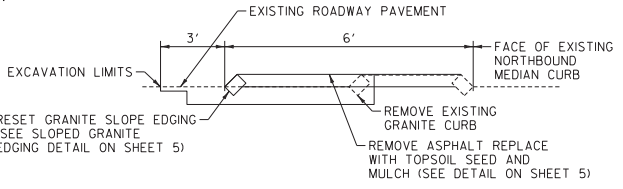

**TYPICAL SECTION 3 - RAISED MEDIAN ISLAND**  
 US ROUTE 7 - KOCHER DRIVE TO APPROX. 315 FEET NORTH OF KOCHER DRIVE

- CONSTRUCTION NOTES**
1. ALL MATERIALS USED AND CONSTRUCTION SHALL COMPLY WITH THE 2018 VTRANS STANDARD SPECIFICATIONS. ALL WORK SHALL BE COMPLETED IN A NORMALISE MANNER AND SHALL BE COMPLETED IN THE TIME SPECIFIED BY THE OWNER.
  2. NEW PATH SHALL BE CONSTRUCTED TO LINE AND GRADE SHOWN ON DRAWINGS.
  3. METHODS FOR PREPARATION OF SUBGRADE SHALL CONFORM TO THE 2018 VERMONT AGENCY OF TRANSPORTATION SPECIFICATIONS SECTION 205.12.
  4. ANY SUBGRADE DISTURBED BY THE CONTRACTOR, OR RENDERED UNSUITABLE BY CONSTRUCTION MACHINERY SHALL BE REMOVED AND REPLACED WITH APPROVED GRANULAR BACKFILL AT THE CONTRACTOR'S EXPENSE.
  5. SUBGRADE SHALL BE COMPACTED TO 95% OF THE MAXIMUM COMPACTION DENSITY (STANDARD PROCTOR) FOR PATHWAY AND PAVEMENT CONSTRUCTION.
  6. FILL MATERIAL SHALL BE APPROVED BY THE ENGINEER. FILL SHALL BE PLACED IN LIFTS, BETTED AND COMPACTED WITH SATISFACTORY COMPACTION EQUIPMENT. FILL SHALL BE COMPACTED TO 95% OF THE MAXIMUM COMPACTION DENSITY.
  7. GRAVEL SUBBASE FOR SIDEWALK SHALL CONFORM TO THE 2018 VERMONT AGENCY OF TRANSPORTATION SPECIFICATIONS SECTION 204.05B AND PLACEMENT SHALL CONFORM TO SECTION 301.
  8. ALL AREAS DISTURBED DURING CONSTRUCTION SHALL BE RESTORED TO CONDITIONS EQUAL TO OR BETTER THAN THOSE EXISTING AT THE START OF CONSTRUCTION, OR AS OTHERWISE SPECIFIED. SHOULD THE CONTRACTOR DISTURB AREAS BEYOND THE CONSTRUCTION LIMITS, EASEMENTS, OR RIGHT OF WAYS, THIS RESTORATION WILL BE AT THE CONTRACTOR'S EXPENSE. THE CONTRACTOR SHALL SHOW PROOF OF AN AGREEMENT BY THE PROPERTY OWNER PRIOR TO COMMENCING ANY WORK OUTSIDE OF THE CONSTRUCTION LIMITS. THE CONTRACTOR SHALL BE SOLELY RESPONSIBLE FOR ALL EXISTING UTILITIES AND THEIR UNINTERRUPTED SERVICE. ALL OFF-SITE BACKFILL, SHEETING, SHORING, DE-WATERING, EROSION CONTROL, CLEARING, GRUBBING, DUST CONTROL, TRAFFIC CONTROL, GRADING, AND INCIDENTALS TO MAKE THE WORK COMPLETE SHALL BE INCLUDED AS PART OF THE REQUIRED WORK.
  9. THE CONTRACTOR SHALL INSTALL A 1/2" PREMOULDED JOINT FILLER BETWEEN ALL EXISTING TO PROPOSED CONCRETE JOINTS.
- * FILL LINES SHOWN ON DETAILS REPRESENT PAY LIMITS UNLESS NOTED OTHERWISE.

**NOTE:**  
 EARTH BORROW MEETING ASTM D 2487 SOIL CLASSIFICATION GROUPS GW, GP, GM, SW, SP, AND SM; FREE OF ROCK OR GRAVEL LARGER THAN 6 INCHES IN ANY DIMENSION, FREE FROM STRUCTURALLY WEAK PIECES, THIN OR ELONGATED PIECES, DEBRIS, WASTE, FROZEN MATERIALS, VEGETATION AND OTHER DELETERIOUS MATTER.



**MSK ENGINEERING AND DESIGN, INC.**  
 P.O. BOX 139, 150 DEPOT STREET  
 BENNINGTON, VERMONT 05201  
 PH: (802) 447-1402 FAX: (802) 445-1291

**MILONE & MacBROOM***  
 1 South Main Street, 2nd Floor  
 Waterbury, Vermont 05676  
 (802) 882-8335 Fax (802) 882-8346  
 www.miloneandmacbroom.com

PROJECT NAME:	KOCHER DRIVE	PLOT DATE:	10/1/2019
PROJECT NUMBER:	STP SDWK (I2) & STP BP18 (I4)	DRAWN BY:	N. YOSKOWITZ
FILE NAME:	zSTP0DKW12+yp	CHECKED BY:	J. DOLMETSCH
PROJECT LEADER:	J. DOLMETSCH	SHEET	4 OF 29
DESIGNED BY:	J. DOLMETSCH		
TYPICAL DETAILS			

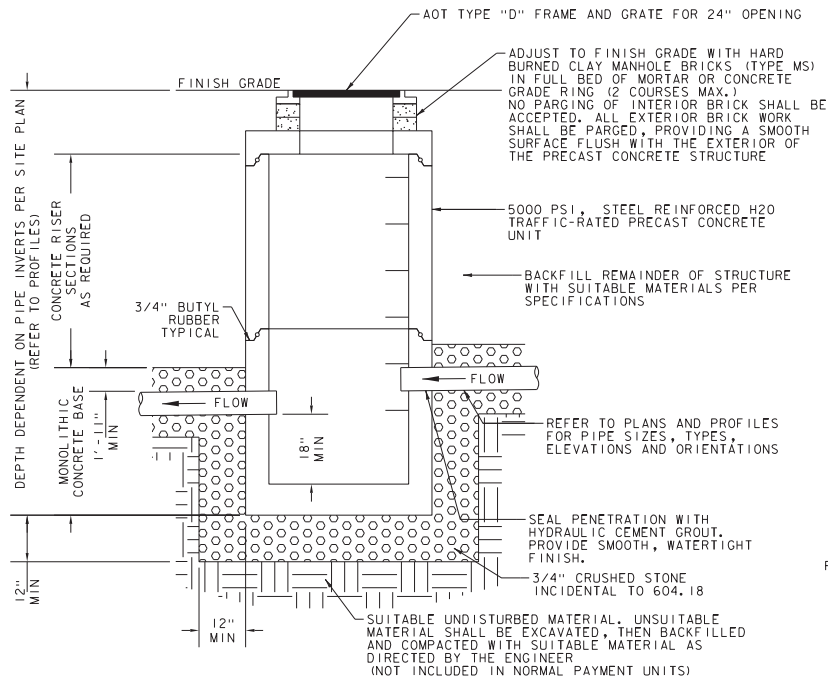

**DROP INLET TYPICAL**  
NOT TO SCALE

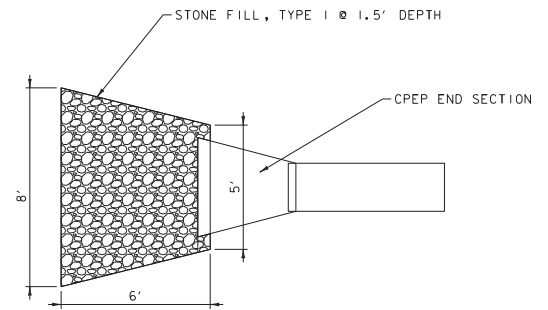

**OUTLET EROSION PROTECTION PAD**  
NOT TO SCALE

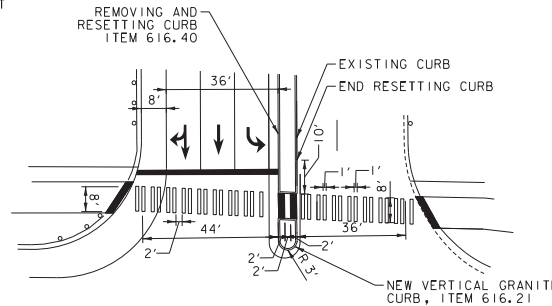

**CROSSWALK PAVEMENT MARKINGS DETAIL**  
1" = 20'

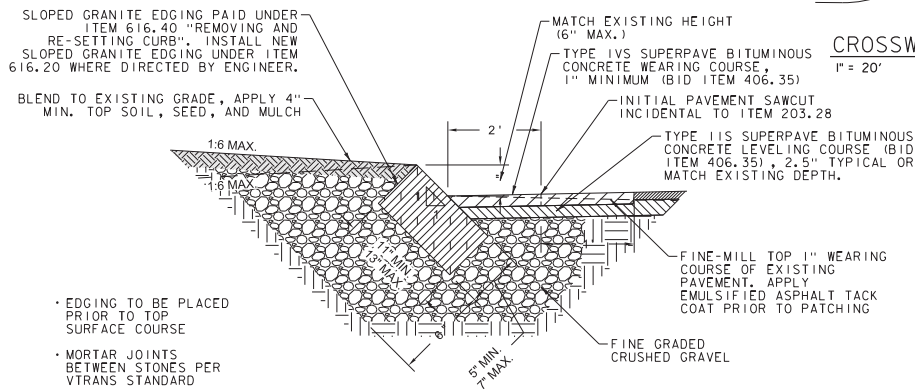

**SLOPED GRANITE EDGING DETAIL ***  
* SUPERCEDES VTRANS TYPICAL NOT TO SCALE

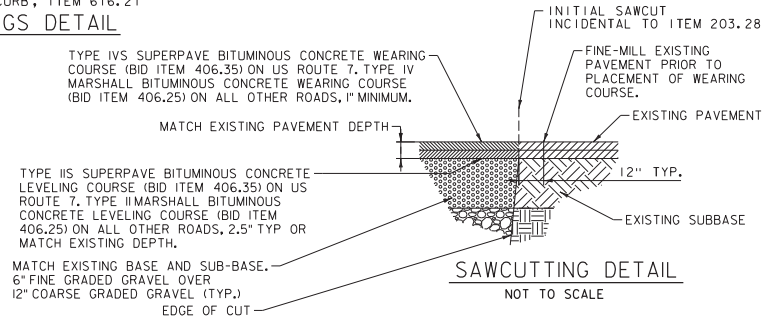

**SAWCUTTING DETAIL**  
NOT TO SCALE



**MSK ENGINEERING AND DESIGN, INC.**  
P.O. BOX 139, 150 DEPOT STREET  
BENNINGTON, VERMONT 05201  
PH: (802) 447-1402 FAX: (802) 445-1291

**MILONE & MACBROOM***  
1 South Main Street, 2nd Floor  
Waterbury, Vermont 05676  
(802) 882-8335 Fax (802) 882-8346  
www.miloneandmacbroom.com

PROJECT NAME:	KOCHER DRIVE	FILE NAME:	zSTPSDWK12+yp2	PLOT DATE:	10/1/2019
PROJECT NUMBER:	STP SDWK (I2) & STP BP18 (I4)	PROJECT LEADER:	J. DOLMETSCH	DRAWN BY:	N. YOSKOWITZ
		DESIGNED BY:	J. DOLMETSCH	CHECKED BY:	J. DOLMETSCH
		TYPICAL DETAILS			SHEET 5 OF 29



# QUANTITY SHEET 2

SUMMARY OF ESTIMATED QUANTITIES										TOTALS			DESCRIPTIONS			DETAILED SUMMARY OF QUANTITIES							
										ROADWAY	EROSION CONTROL	BRIDGE	FULL C.E. ITEMS	BRIDGE QUANTITY	ROUND	GRAND TOTAL	FINAL	UNIT	ITEMS	ITEM NUMBER	QUANTITIES	UNIT	ITEMS
											606					606		CY	TOPSOIL	651.35			
											1416					1416		SY	ROLLED EROSION CONTROL PRODUCT, TYPE 1	653.20			
											2					2		EACH	INLET PROTECTION DEVICE, TYPE II	653.41			
											535					535		LF	SILT FENCE, TYPE 1	653.475			
											20					20		SF	TRAFFIC SIGNS, TYPE A	675.20			
											60					60		LF	SQUARE TUBE SIGN POSTS AND ANCHOR	675.341			
											3					3		EACH	REMOVING SIGNS	675.50			
											1					1		EACH	RESETTING SIGNS	675.60			
											370					370		LF	ELECTRICAL CONDUIT	678.21			
											519					519		LF	WIRED CONDUIT	678.23			
											367					367		LF	ELECTRICAL WIRING	678.24			
											8					8		EACH	JUNCTION BOX	678.26			
											341					341		LF	SPECIAL PROVISION (HORIZONTAL DIRECTIONAL DRILLING - 10" UTILITY SLEEVE)	900.640			
											1					1		LS	SPECIAL PROVISION (RELOCATE EXISTING OVERHEAD SIGN)	900.6450			
											1					1		LS	SPECIAL PROVISION (HYDRANT EXTENSION)	900.6451			
											1					1		LS	SPECIAL PROVISION (PREFABRICATED PEDESTRIAN BRIDGE SUPERSTRUCTURE)	900.6452			
											1					1		LS	SPECIAL PROVISION ( VIDEO DETECTION ZONE ADJUSTMENT ) ( VT 7A & BENMONT AVENUE )	900.6453			
											1					1		LS	SPECIAL PROVISION ( VIDEO DETECTION ZONE ADJUSTMENT ) ( US 7 & KOCHER DRIVE )	900.6454			
											1					1		LS	SPECIAL PROVISION ( PEDESTRIAN SIGNAL EQUIPMENT ) ( VT 7A & BENMONT AVENUE )	900.6455			
											1					1		LS	SPECIAL PROVISION ( PEDESTRIAN SIGNAL EQUIPMENT ) ( US 7 & KOCHER DRIVE )	900.6456			

PROJECT NAME: KOCHER DRIVE	
PROJECT NUMBER: STP SDWK (I2) & STP BP18 (I4)	
FILE NAME: zSTPSDWK12.qty	PLOT DATE: 10-1-2019
PROJECT LEADER: J. DOLMETSCH	DRAWN BY: N. YOSKOWITZ
DESIGNED BY: J. DOLMETSCH	CHECKED BY: J. DOLMETSCH
QUANTITY SHEET (2)	SHEET 7 OF 29



# BRIDGE QUANTITY SHEET 1

SUMMARY OF ESTIMATED QUANTITIES													TOTALS		DESCRIPTIONS			DETAILED SUMMARY OF QUANTITIES		
													BRIDGE TOTAL	UNIT	ITEMS		ITEM NUMBER	QUANTITIES	UNIT	ITEMS
													60				204.25			
													40				204.30			
													1750				507.11			
													18				541.25			

PROJECT NAME:	KOCHER DRIVE		
PROJECT NUMBER:	STP SDWK (I2) & STP BPI8 (I4)		
FILE NAME:	zSTPSDWWI2.qty	PLOT DATE:	10-1-2019
PROJECT LEADER:	J. DOLMETSCH	DRAWN BY:	N. YOSKOWITZ
DESIGNED BY:	J. DOLMETSCH	CHECKED BY:	J. DOLMETSCH
BRIDGE QUANTITY SHEET (I)		SHEET	8 OF 29

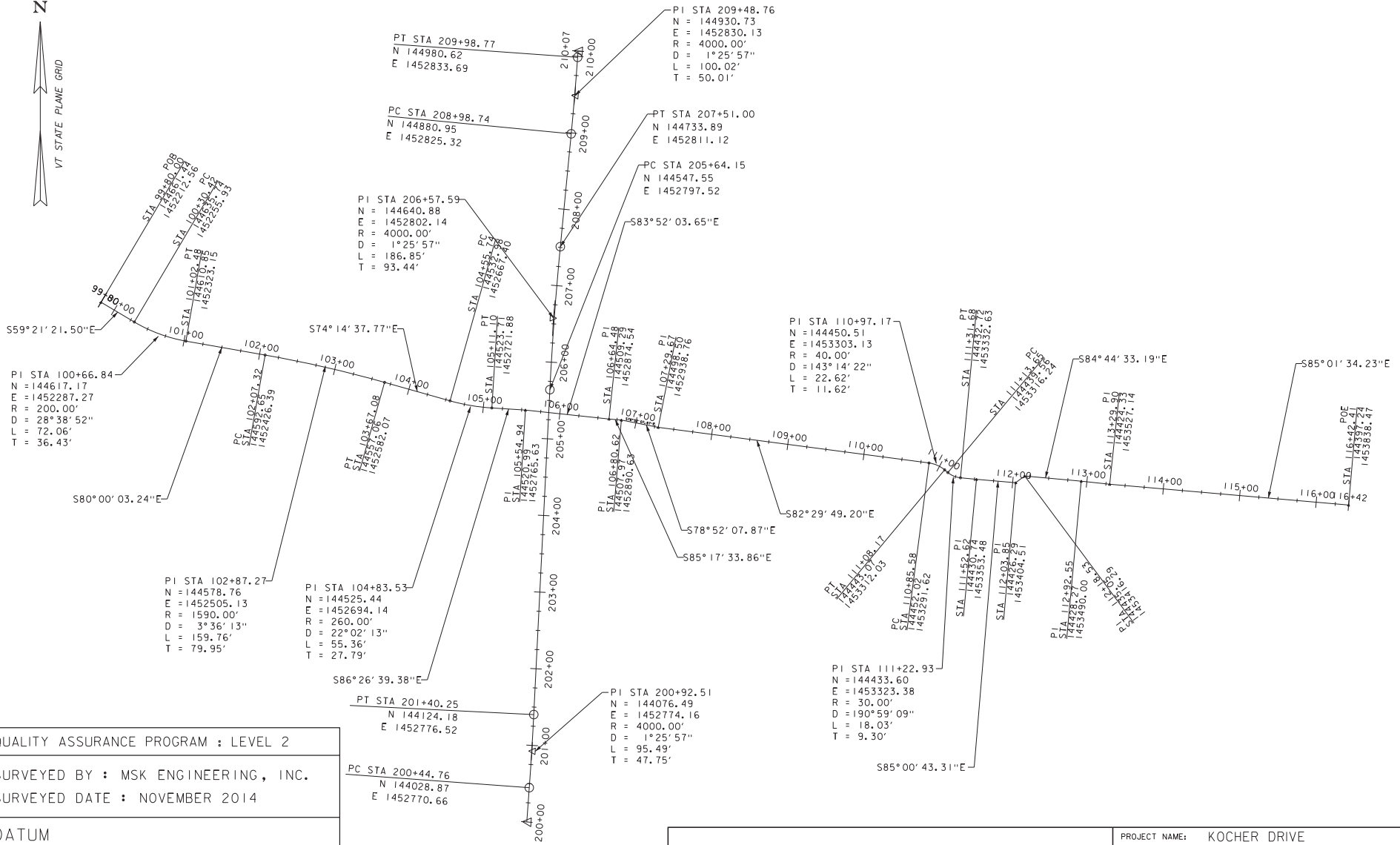

QUALITY ASSURANCE PROGRAM : LEVEL 2

SURVEYED BY : MSK ENGINEERING, INC.  
 SURVEYED DATE : NOVEMBER 2014

DATUM  
 VERTICAL: NAVD 1988  
 HORIZONTAL: NAD 1983



**MSK ENGINEERING AND DESIGN, INC.**  
 P.O. BOX 10, 150 DEPOT STREET  
 BENNINGTON, VERMONT 05201  
 PH: (802) 447-1402 FAX: (802) 445-1251

**MILONE & MACBROOM**  
 1 South Main Street, 2nd Floor  
 Waterbury, Vermont 05676  
 (802) 882-8335 Fax (802) 882-8346  
 www.miloneandmacbroom.com

PROJECT NAME:	KOCHER DRIVE		
PROJECT NUMBER:	STP SDWK (I2) & STP BP18 (I4)		
FILE NAME:	zSTPSPDWK12_algbrd.dgn	PLOT DATE:	10/11/2019
PROJECT LEADER:	J. DOLMETSCH	DRAWN BY:	N.YOSKOWITZ
DESIGNED BY:	J. DOLMETSCH	CHECKED BY:	J. DOLMETSCH
ALIGNMENT LAYOUT SHEET		SHEET	9 OF 29

**MARSHALL BITUMINOUS CONCRETE PAVEMENT**  
100+46.25 - 105+00.00

**DETECTABLE WARNING SURFACE**  
100+03 LT  
100+42 LT

**PORTLAND CEMENT CONCRETE SIDEWALK, 5 INCH**  
99+94.37 - 100+04.78  
100+38.05 - 100+46.25

**DURABLE 24 INCH STOP BAR, EPOXY PAINT**  
100+05.00 LT - 100+20.00 LT

**DURABLE CROSSWALK MARKING, EPOXY PAINT**  
100+06.00 - 100+36.00

**FINE MILLING, BITUMINOUS PAVEMENT**  
100+00.00 - 100+75.00

**CAST-IN-PLACE CONCRETE CURB, TYPE B**  
100+00.00 - 100+05.00

**REMOVAL AND DISPOSAL OF GUARDRAIL**  
100+45.85 - 100+47.50  
104+70.00 - 105+00.00



MATCHLINE LAYOUT SHEET 2

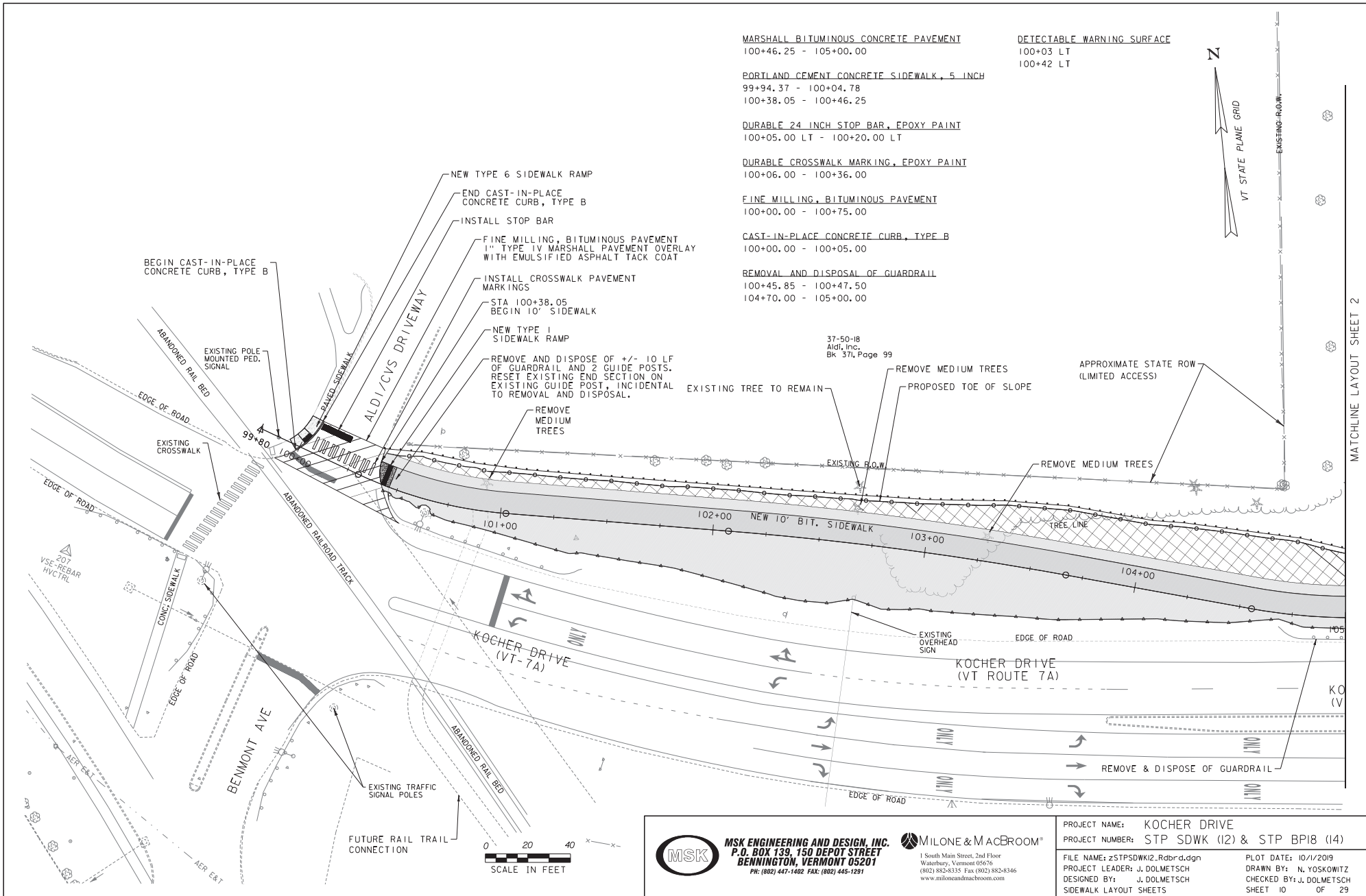

**MSK ENGINEERING AND DESIGN, INC.**  
P.O. BOX 139, 150 DEPOT STREET  
BENNINGTON, VERMONT 05201  
PH: (802) 447-1402 FAX: (802) 445-1291

**MILONE & MacBROOM®**  
1 South Main Street, 2nd Floor  
Waterbury, Vermont 05676  
(802) 882-8335 Fax (802) 882-8346  
www.miloneandmacbroom.com

PROJECT NAME:	KOCHER DRIVE	PLAT DATE:	10/1/2019
PROJECT NUMBER:	STP SDWK (I2) & STP BP18 (I4)	DRAWN BY:	N. YOSKOWITZ
FILE NAME:	zSTPSDWK12_Rdbr.dgn	CHECKED BY:	J. DOLMETSCH
PROJECT LEADER:	J. DOLMETSCH	SHEET	10 OF 29
DESIGNED BY:	J. DOLMETSCH		
SIDEWALK LAYOUT SHEETS			

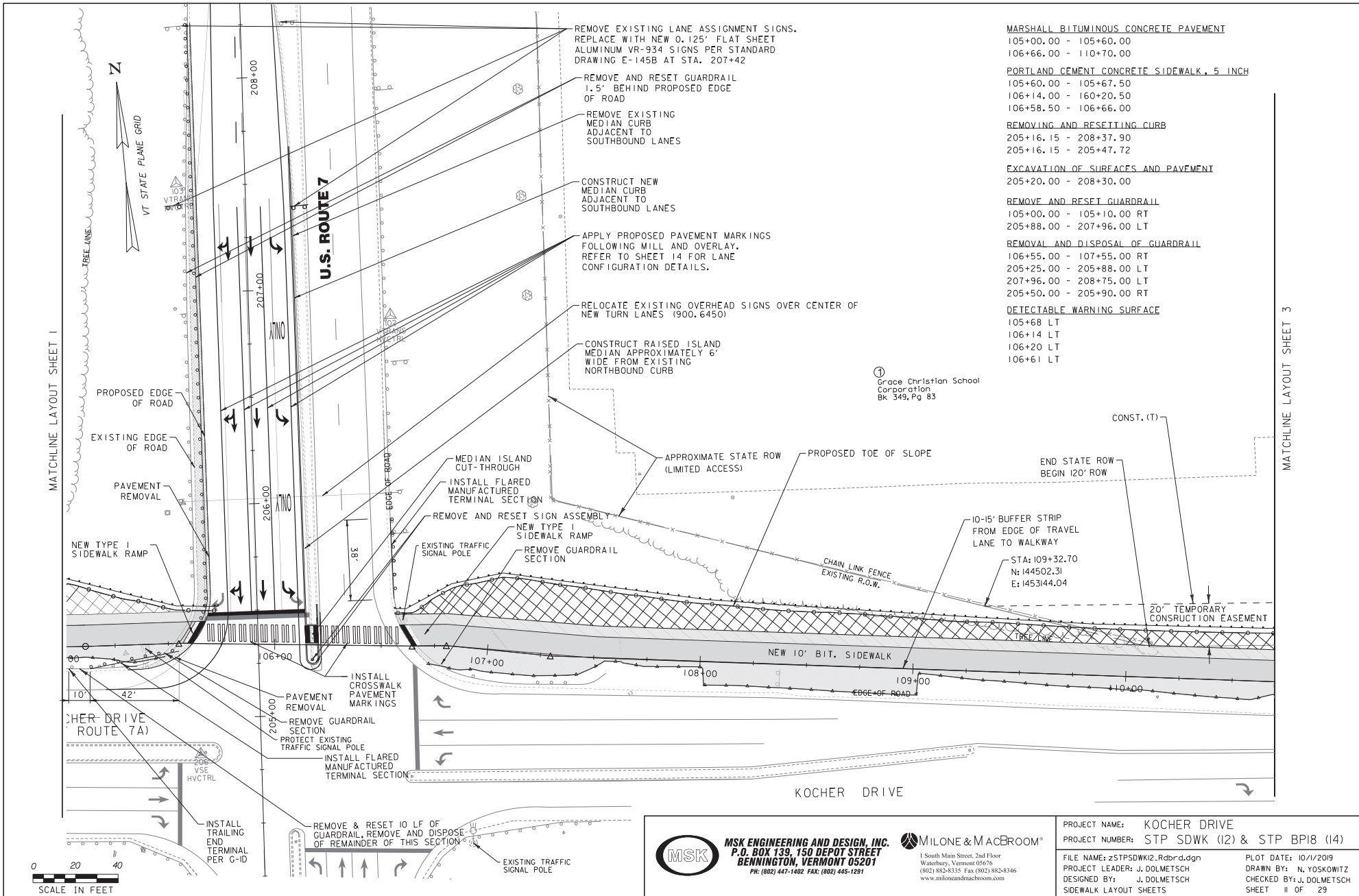

- MARSHALL BITUMINOUS CONCRETE PAVEMENT**  
 105+00.00 - 105+60.00  
 106+66.00 - 110+70.00
- PORTLAND CEMENT CONCRETE SIDEWALK, 5 INCH**  
 105+60.00 - 105+67.50  
 106+14.00 - 160+20.50  
 106+58.50 - 106+66.00
- REMOVING AND RESETTING CURB**  
 205+16.15 - 208+37.90  
 205+16.15 - 205+47.72
- EXCAVATION OF SURFACES AND PAVEMENT**  
 205+20.00 - 208+30.00
- REMOVE AND RESET GUARDRAIL**  
 105+00.00 - 105+10.00 RT  
 205+88.00 - 207+96.00 LT
- REMOVAL AND DISPOSAL OF GUARDRAIL**  
 106+55.00 - 107+55.00 RT  
 205+25.00 - 205+88.00 LT  
 207+96.00 - 208+75.00 LT  
 205+50.00 - 205+90.00 RT
- DETECTABLE WARNING SURFACE**  
 105+68 LT  
 106+14 LT  
 106+20 LT  
 106+61 LT

① Grace Christian School Corporation  
 Bk 349, Pg 83

PROJECT NAME: KOCHER DRIVE  
 PROJECT NUMBER: STP SDWK (I2) & STP BP18 (I4)  
 FILE NAME: zSTPsdwk12_Rdbr-d.dgn  
 PROJECT LEADER: J. DOLMETSCH  
 DESIGNED BY: J. DOLMETSCH  
 SIDEWALK LAYOUT SHEETS

PLOT DATE: 10/1/2019  
 DRAWN BY: N. YOSKOWITZ  
 CHECKED BY: J. DOLMETSCH  
 SHEET 11 OF 29



**MSK ENGINEERING AND DESIGN, INC.**  
 P.O. BOX 139, 150 DEPOT STREET  
 BENNINGTON, VERMONT 05201  
 PH: (802) 447-1402 FAX: (802) 445-1291

**MILONE & MACBROOM**[®]  
 1 South Main Street, 2nd Floor  
 Waterbury, Vermont 05676  
 (802) 882-8335 Fax (802) 882-8346  
 www.miloneandmacbroom.com

MATCHLINE LAYOUT SHEET 1

MATCHLINE LAYOUT SHEET 3

MATCHLINE LAYOUT SHEET 2

**DETECTABLE WARNING SURFACE**  
111+66 LT  
112+01 LT  
115+87 LT

**MARSHALL BITUMINOUS CONCRETE PAVEMENT**  
110+70.00 - 111+52.50  
112+09.60 - 112+18.50  
112+92.50 - 115+83.50

**PORTLAND CEMENT CONCRETE SIDEWALK, 5 INCH**  
111+52.50 - 111+69.80  
111+97.80 - 112+09.60  
115+83+50 - 115+91.60

**VERTICAL GRANITE CURB**  
111+31.67 LT - 111+70.76 LT  
111+21.50 RT - 111+58.40 LT (APPROX 107 LF)  
111+94.49 LT - 112+07.67 RT (APPROX 47 LF)

**EXCAVATION OF SURFACES AND PAVEMENTS**  
111+25.00 - 111+50.00

STA: 115+81.91  
N: 144426.86  
E: 1453780.33

James F. Langway,  
Trustee of the  
JFL Bennington Realty Trust  
Bk 504, Pg 159

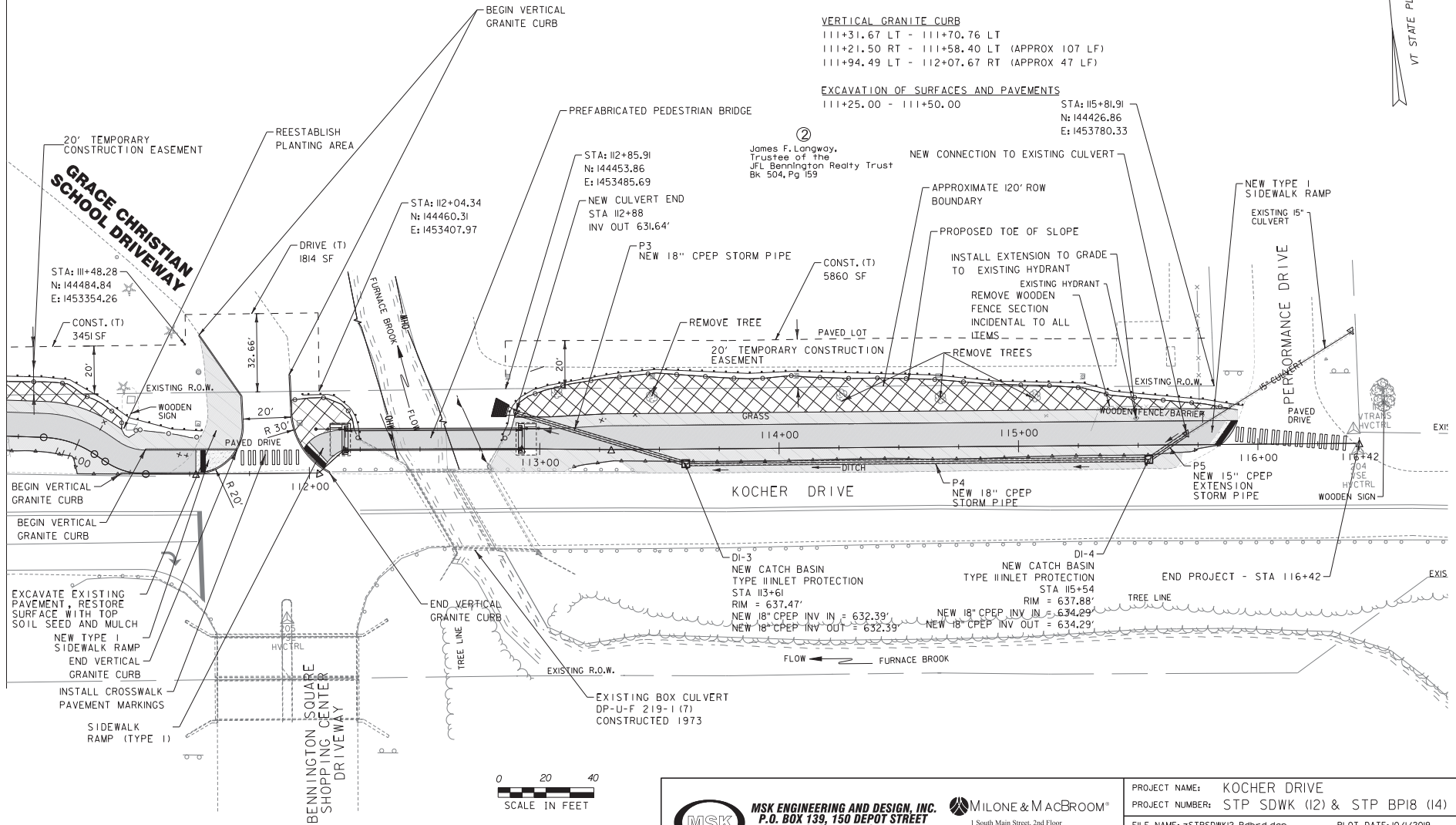

 <b>MSK ENGINEERING AND DESIGN, INC.</b> P.O. BOX 139, 150 DEPOT STREET BENNINGTON, VERMONT 05201 PH: (802) 447-1402 FAX: (802) 445-1291	 <b>MILONE &amp; MACBROOM</b> 1 South Main Street, 2nd Floor Waterbury, Vermont 05676 (802) 882-8335 Fax: (802) 882-8346 www.miloneandmacbroom.com	PROJECT NAME: KOCHER DRIVE PROJECT NUMBER: STP SDWK (12) & STP BP18 (14)	FILE NAME: zSTPSDWK12.Rdbr.dgn PROJECT LEADER: J. DOLMETSCH DESIGNED BY: J. DOLMETSCH SIDEWALK LAYOUT SHEETS	PLOT DATE: 10/1/2019 DRAWN BY: N. YOSKOWITZ CHECKED BY: J. DOLMETSCH SHEET 12 OF 29
		SCALE IN FEET 0 20 40		

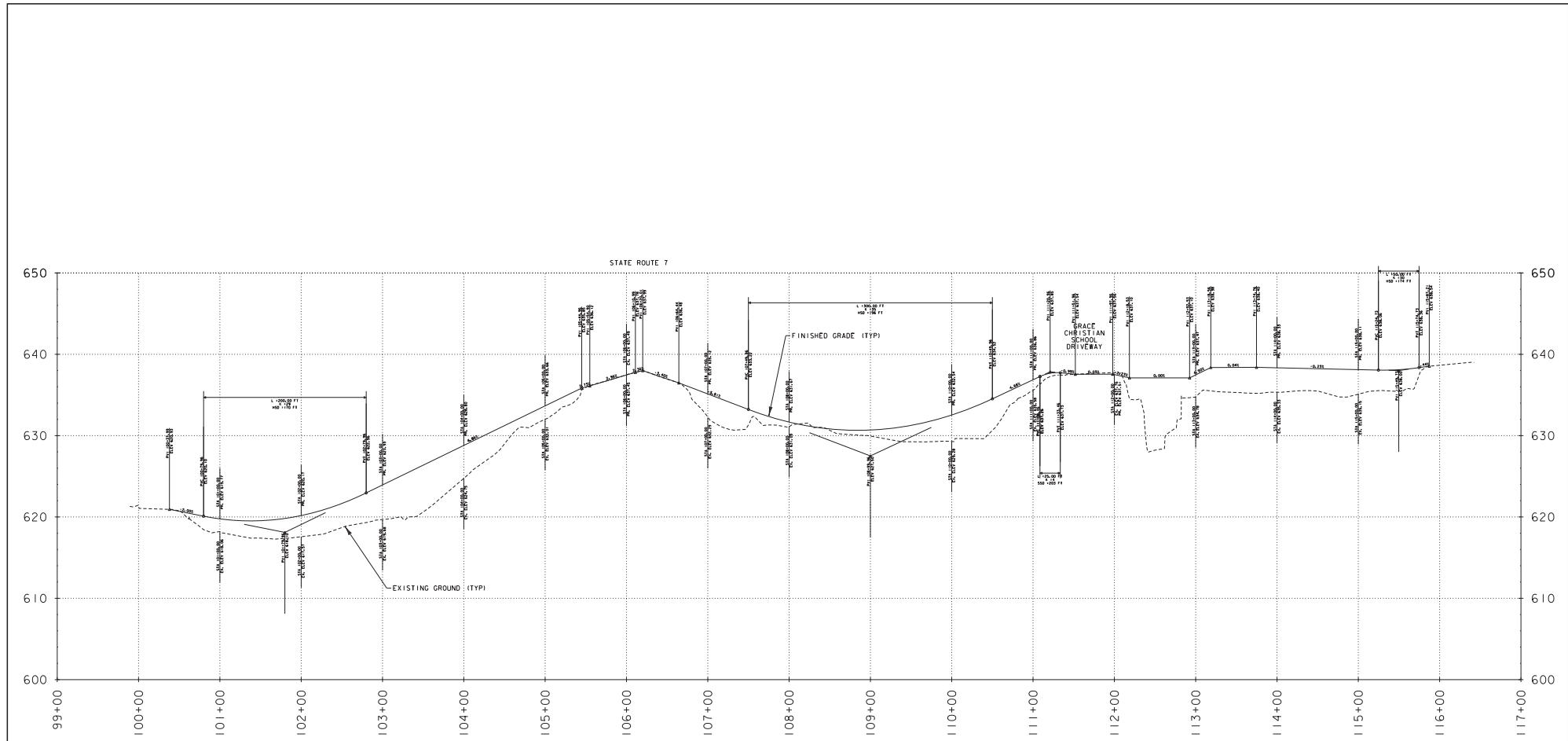

LINE	SURFACE	OFFSET
-----	Kocher_Survey	0.00
	Scaled 10.0000	Times Ver.
	Scaled 1.0000	Times Hor.

 <b>MSK ENGINEERING AND DESIGN, INC.</b> P.O. BOX 139, 150 DEPOT STREET BENNINGTON, VERMONT 05201 PH: (802) 447-1402 FAX: (802) 445-1281	 <b>MILONE &amp; MACBROOM®</b> 1 South Main Street, 2nd Floor Waterbury, Vermont 05676 (802) 882-8335 Fax (802) 882-8346 www.miloneandmacbroom.com	PROJECT NAME: KOCHER DRIVE	PLOT DATE: 10/1/2019
		PROJECT NUMBER: STP SDWK (I2) & STP BP18 (I4)	SHEET 13 OF 29
		FILE NAME: zSPSDWK12.prp	DRAWN BY: N. YOSKOWITZ
		PROJECT LEADER: J. DOLMETSCH	CHECKED BY: J. DOLMETSCH
		DESIGNED BY: J. DOLMETSCH	
		SIDEWALK PROFILE	

DURABLE 6 INCH WHITE LINE - DASH, EPOXY PAINT  
207+42.00 - 209+80.00

DURABLE 6 INCH WHITE LINE - SOLID, EPOXY PAINT  
205+15.91 LT - 209+82.14 LT  
205+45.85 RT - 207+42 RT  
205+48.01 - 207+42

DURABLE 6 INCH YELLOW LINE, EPOXY PAINT  
205+20 RT - 209+80 RT  
205+20 RT - 205+52 RT

DURABLE LETTER OR SYMBOL, EPOXY PAINT  
205+54.00 RT  
205+54.00  
205+54.00 LT  
205+94.50 RT  
206+34.83 RT  
206+34.83  
206+34.83 LT  
206+75.33 RT  
207+15.67 RT  
207+15.67  
207+15.67 LT

DURABLE 24 INCH STOP BAR, EPOXY PAINT  
205+49.71 LT & RT

FINE MILLING, BITUMINOUS PAVEMENT  
205+20 - 209+80

SUPERPAVE BITUMINOUS CONCRETE PAVEMENT  
205+20 - 209+80

DURABLE CROSSWALK MARKING, EPOXY PAINT  
205+31.58 RT - 205+41.20 RT  
205+34.03 RT - 205+44.24 LT

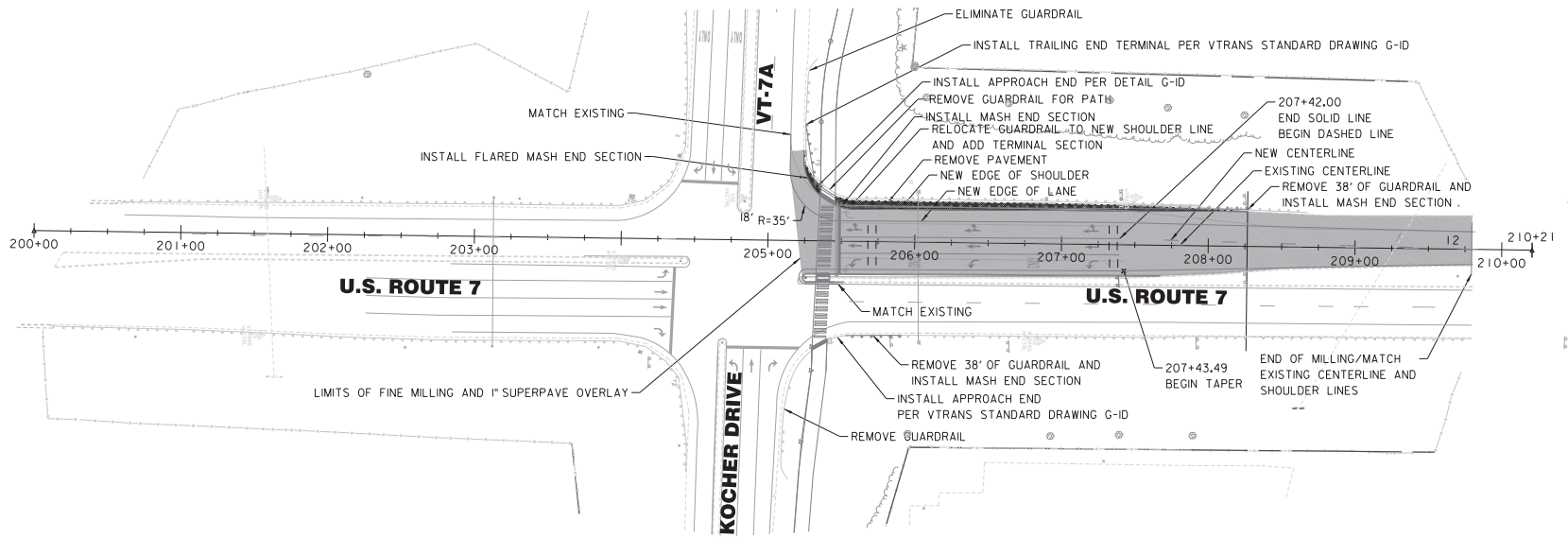

PAVEMENT MARKING DETAIL

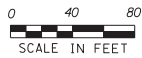

**MSK ENGINEERING AND DESIGN, INC.**  
P.O. BOX 10, 150 DEPOT STREET  
BENNINGTON, VERMONT 05201  
PH: (802) 447-1402 FAX: (802) 445-1291

**MILONE & MacBROOM®**  
1 South Main Street, 2nd Floor  
Waterbury, Vermont 05676  
(802) 882-8335 Fax (802) 882-8346  
www.miloneandmacbroom.com

PROJECT NAME:	KOCHER DRIVE	PLOT DATE:	10/1/2019
PROJECT NUMBER:	STP SDWK (I2) & STP BP18 (I4)	DRAWN BY:	N. YOSKOWITZ
FILE NAME:	zSTPSDWK12.rdde+tl.dgn	CHECKED BY:	J. DOLMETSCH
PROJECT LEADER:	J. DOLMETSCH	PAVEMENT MARKING DETAIL	SHEET 14 OF 29
DESIGNED BY:	J. DOLMETSCH		

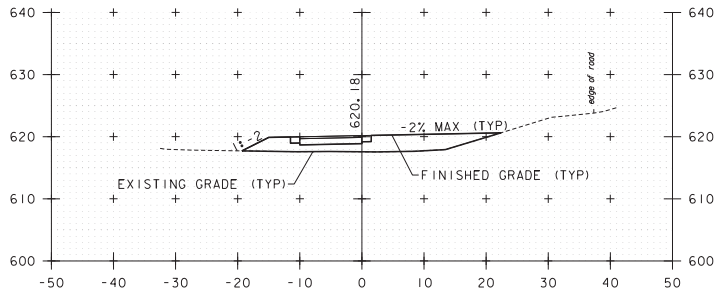

102+00

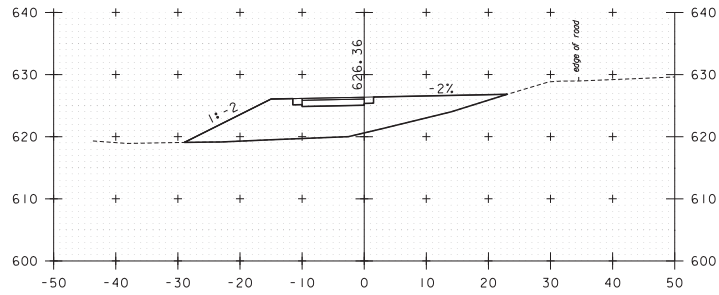

103+50

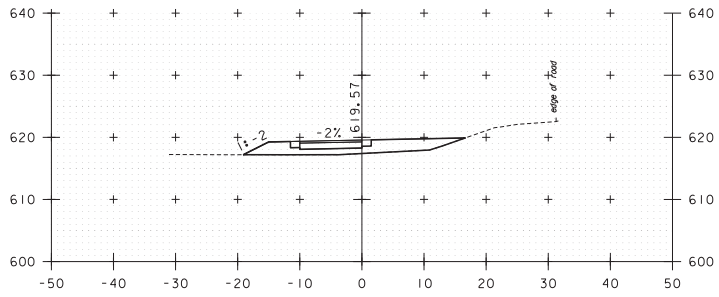

101+50

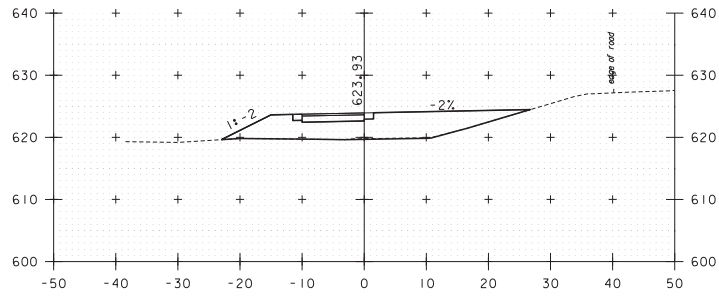

103+00

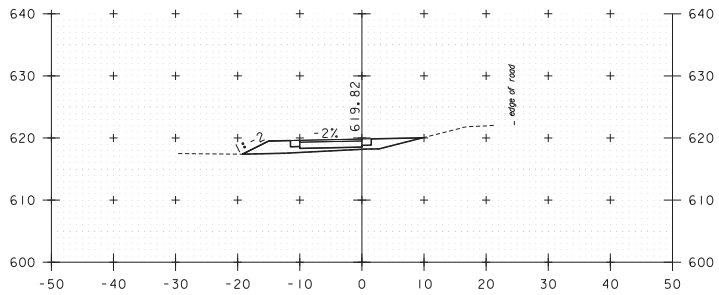

101+00

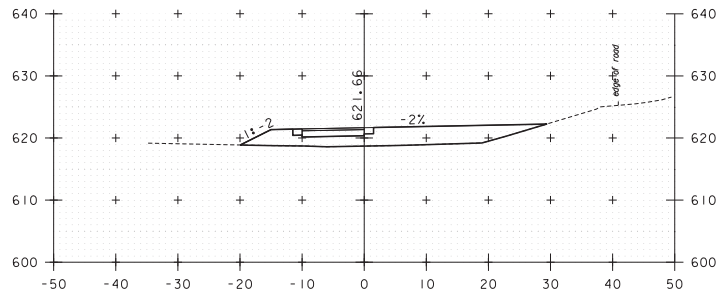

102+50

STA. 101+00 TO STA. 103+50

PROJECT NAME:	KOCHER DRIVE	PLOT DATE:	10/1/2019
PROJECT NUMBER:	STP SDWK (I2) & STP BP18 (I4)	DRAWN BY:	N. YOSKOWITZ
FILE NAME:	zSTPSDWK12.cs	CHECKED BY:	J. DOLMETSCH
PROJECT LEADER:	J. DOLMETSCH	DESIGNED BY:	J. DOLMETSCH
CROSS SECTIONS		SHEET	15 OF 29



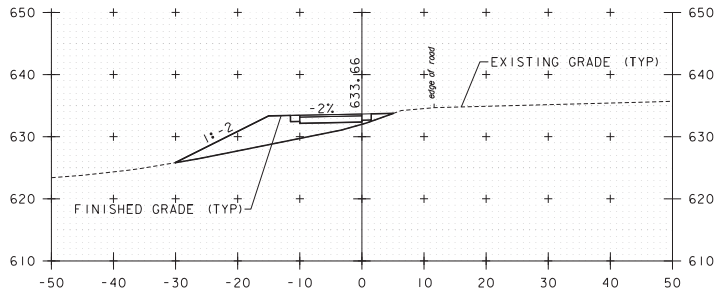

105+00

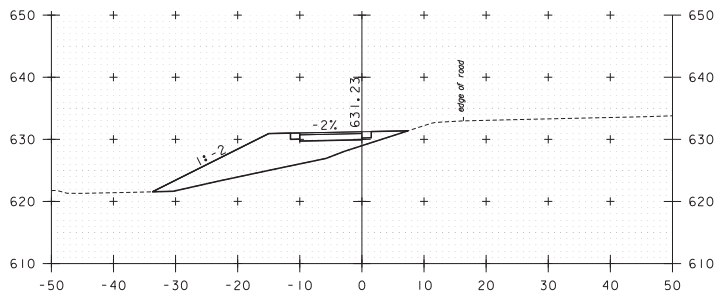

104+50

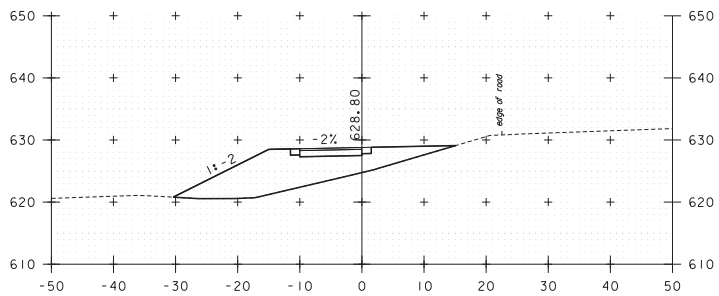

104+00

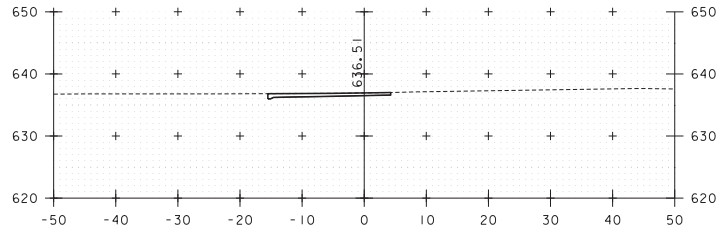

106+50

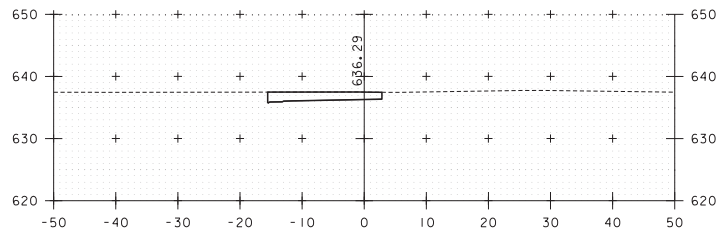

106+00

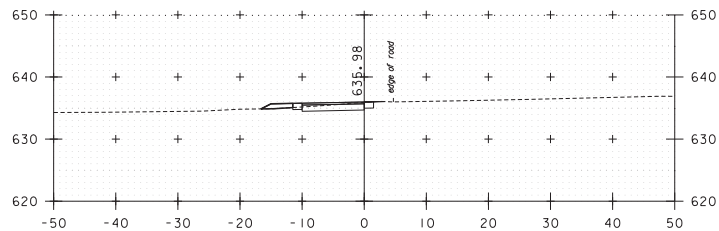

105+50

STA. 104+00 TO STA. 106+50

PROJECT NAME:	KOCHER DRIVE	PLOT DATE:	10/1/2019
PROJECT NUMBER:	STP SDWK (I2) & STP BP18 (I4)	DRAWN BY:	N. YOSKOWITZ
FILE NAME:	zSTPSDWK12.cs	DESIGNED BY:	J. DOLMETSCH
PROJECT LEADER:	J. DOLMETSCH	CHECKED BY:	J. DOLMETSCH
CROSS SECTIONS		SHEET	16 OF 29

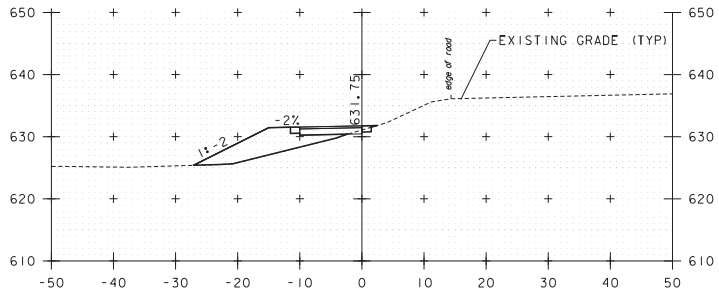

108+00

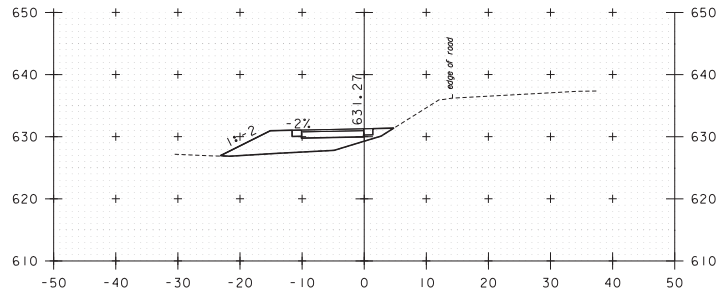

109+50

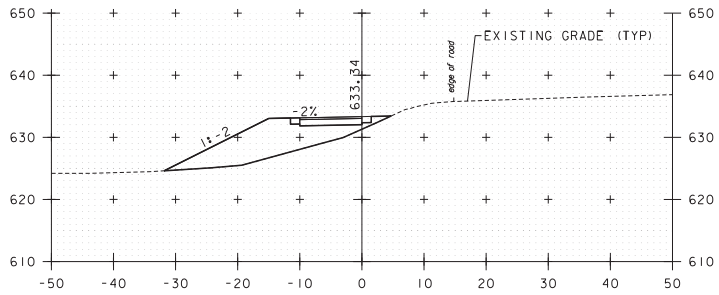

107+50

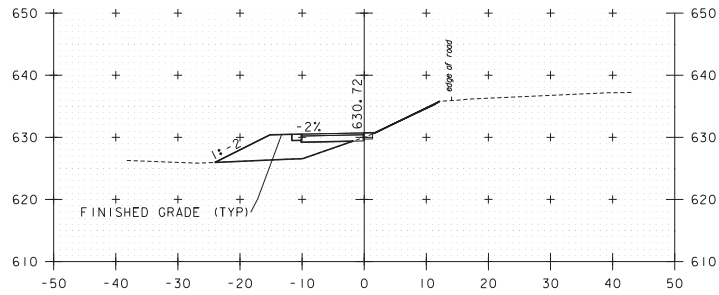

109+00

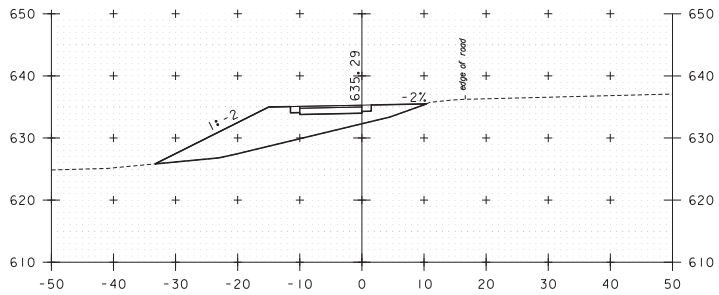

107+00

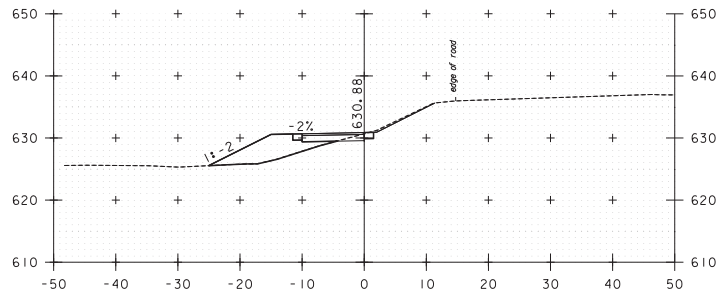

108+50

STA. 107+00 TO STA. 109+50

PROJECT NAME:	KOCHER DRIVE	
PROJECT NUMBER:	STP SDWK (I2) & STP BP18 (I4)	
FILE NAME:	zSTPSDWK12.cs	PLOT DATE: 10/1/2019
PROJECT LEADER:	J. DOLMETSCH	DRAWN BY: N. YOSKOWITZ
DESIGNED BY:	J. DOLMETSCH	CHECKED BY: J. DOLMETSCH
CROSS SECTIONS		SHEET 17 OF 29

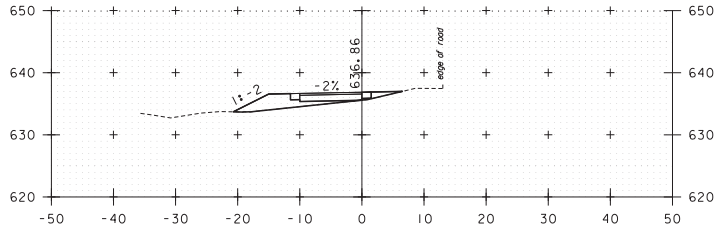

111+00

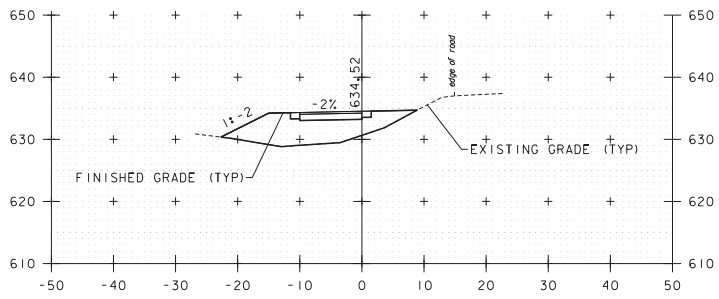

110+50

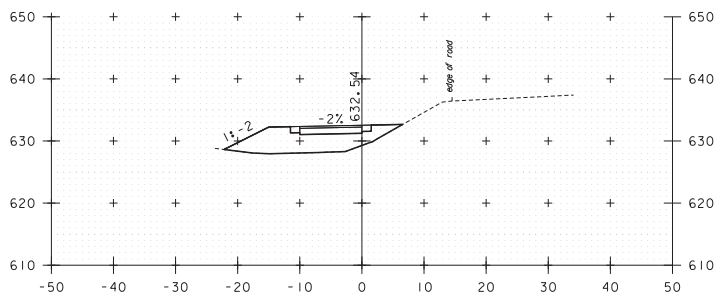

110+00

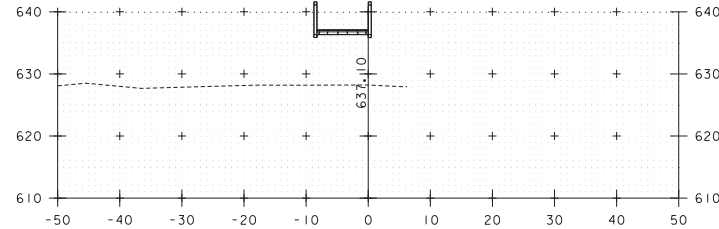

112+50

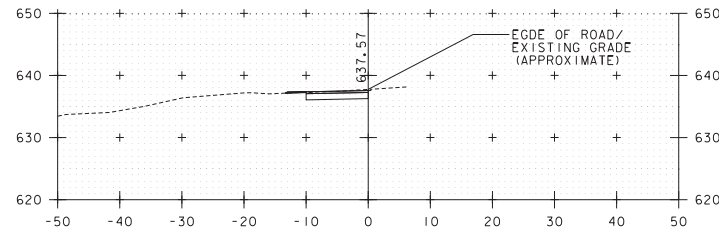

112+00

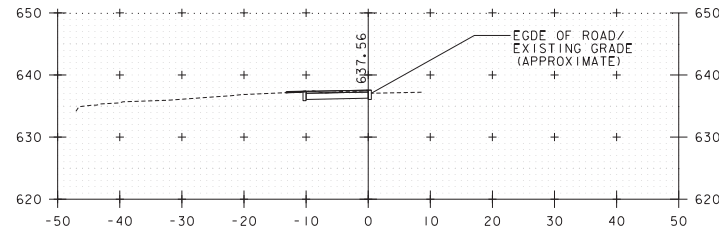

111+50

STA. 110+00 TO STA. 112+50

PROJECT NAME:	KOCHER DRIVE	PLOT DATE:	10//2019
PROJECT NUMBER:	STP SDWK (I2) & STP BP18 (I4)	DRAWN BY:	N. YOSKOWITZ
FILE NAME:	zSTPSDWK12.cs	DESIGNED BY:	J. DOLMETSCH
PROJECT LEADER:	J. DOLMETSCH	CHECKED BY:	J. DOLMETSCH
CROSS SECTIONS		SHEET	18 OF 29

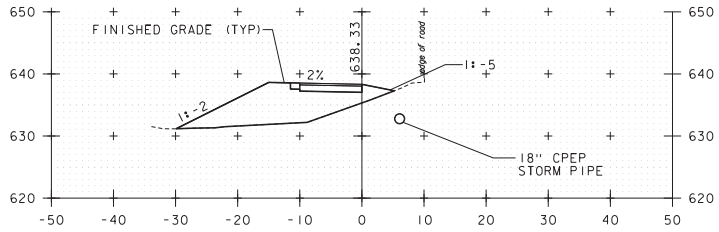

114+00

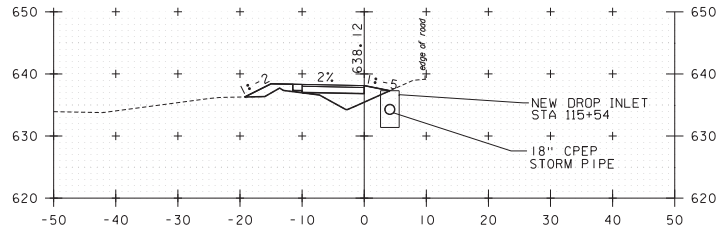

115+50

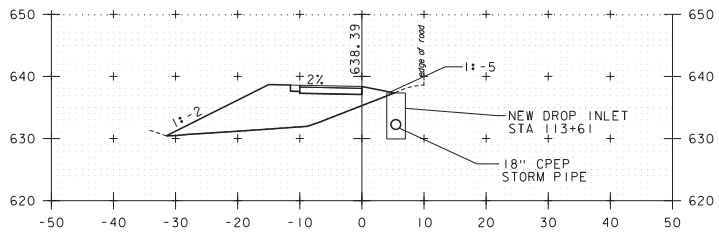

113+50

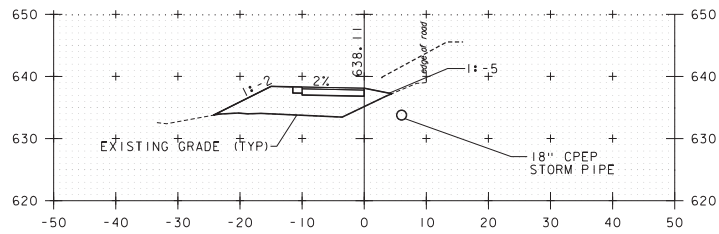

115+00

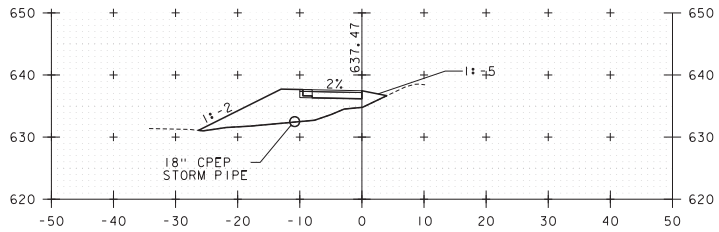

113+00

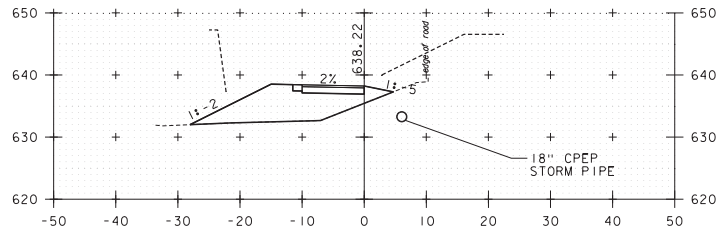

114+50

STA. 113+00 TO STA. 115+50

PROJECT NAME:	KOCHER DRIVE	
PROJECT NUMBER:	STP SDWK (I2) & STP BP18 (I4)	
FILE NAME:	zSTPSDWK12.cs	PLOT DATE: 10/1/2019
PROJECT LEADER:	J. DOLMETSCH	DRAWN BY: N. YOSKOWITZ
DESIGNED BY:	J. DOLMETSCH	CHECKED BY: J. DOLMETSCH
CROSS SECTIONS		SHEET 19 OF 29

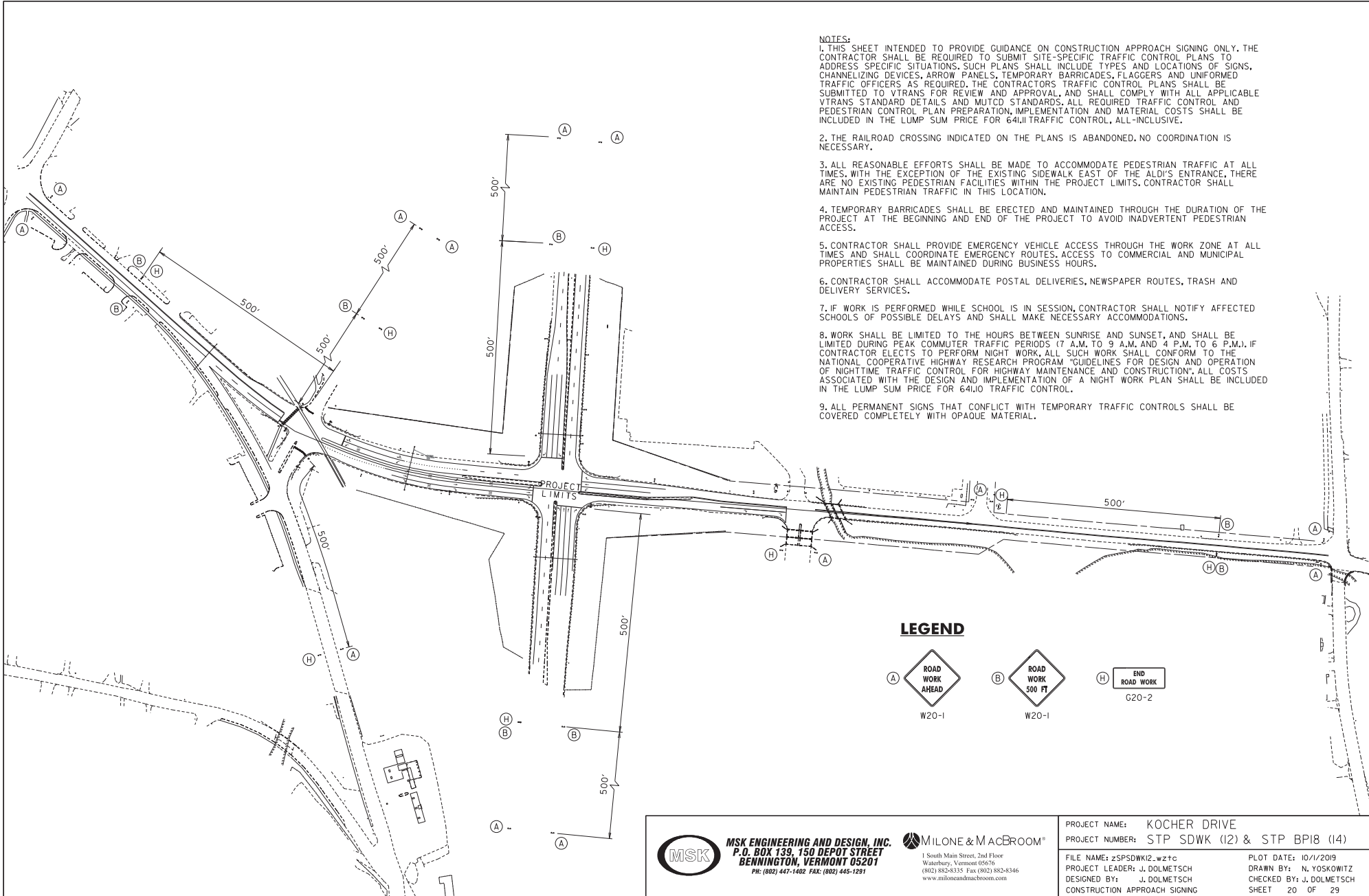

**NOTES:**

1. THIS SHEET INTENDED TO PROVIDE GUIDANCE ON CONSTRUCTION APPROACH SIGNING ONLY. THE CONTRACTOR SHALL BE REQUIRED TO SUBMIT SITE-SPECIFIC TRAFFIC CONTROL PLANS TO ADDRESS SPECIFIC SITUATIONS. SUCH PLANS SHALL INCLUDE TYPES AND LOCATIONS OF SIGNS, CHANNELIZING DEVICES, ARROW PANELS, TEMPORARY BARRICADES, FLAGGERS AND UNIFORMED TRAFFIC OFFICERS AS REQUIRED. THE CONTRACTORS TRAFFIC CONTROL PLANS SHALL BE SUBMITTED TO VTRANS FOR REVIEW AND APPROVAL, AND SHALL COMPLY WITH ALL APPLICABLE VTRANS STANDARD DETAILS AND MUTCD STANDARDS. ALL REQUIRED TRAFFIC CONTROL AND PEDESTRIAN CONTROL PLAN PREPARATION, IMPLEMENTATION AND MATERIAL COSTS SHALL BE INCLUDED IN THE LUMP SUM PRICE FOR 64L11 TRAFFIC CONTROL, ALL-INCLUSIVE.

2. THE RAILROAD CROSSING INDICATED ON THE PLANS IS ABANDONED. NO COORDINATION IS NECESSARY.

3. ALL REASONABLE EFFORTS SHALL BE MADE TO ACCOMMODATE PEDESTRIAN TRAFFIC AT ALL TIMES. WITH THE EXCEPTION OF THE EXISTING SIDEWALK EAST OF THE ALDI'S ENTRANCE, THERE ARE NO EXISTING PEDESTRIAN FACILITIES WITHIN THE PROJECT LIMITS. CONTRACTOR SHALL MAINTAIN PEDESTRIAN TRAFFIC IN THIS LOCATION.

4. TEMPORARY BARRICADES SHALL BE ERECTED AND MAINTAINED THROUGH THE DURATION OF THE PROJECT AT THE BEGINNING AND END OF THE PROJECT TO AVOID INADVERTENT PEDESTRIAN ACCESS.

5. CONTRACTOR SHALL PROVIDE EMERGENCY VEHICLE ACCESS THROUGH THE WORK ZONE AT ALL TIMES AND SHALL COORDINATE EMERGENCY ROUTES. ACCESS TO COMMERCIAL AND MUNICIPAL PROPERTIES SHALL BE MAINTAINED DURING BUSINESS HOURS.

6. CONTRACTOR SHALL ACCOMMODATE POSTAL DELIVERIES, NEWSPAPER ROUTES, TRASH AND DELIVERY SERVICES.

7. IF WORK IS PERFORMED WHILE SCHOOL IS IN SESSION, CONTRACTOR SHALL NOTIFY AFFECTED SCHOOLS OF POSSIBLE DELAYS AND SHALL MAKE NECESSARY ACCOMMODATIONS.

8. WORK SHALL BE LIMITED TO THE HOURS BETWEEN SUNRISE AND SUNSET, AND SHALL BE LIMITED DURING PEAK COMMUTER TRAFFIC PERIODS (7 A.M. TO 9 A.M. AND 4 P.M. TO 6 P.M.). IF CONTRACTOR ELECTS TO PERFORM NIGHT WORK, ALL SUCH WORK SHALL CONFORM TO THE NATIONAL COOPERATIVE HIGHWAY RESEARCH PROGRAM "GUIDELINES FOR DESIGN AND OPERATION OF NIGHTTIME TRAFFIC CONTROL FOR HIGHWAY MAINTENANCE AND CONSTRUCTION". ALL COSTS ASSOCIATED WITH THE DESIGN AND IMPLEMENTATION OF A NIGHT WORK PLAN SHALL BE INCLUDED IN THE LUMP SUM PRICE FOR 64L10 TRAFFIC CONTROL.

9. ALL PERMANENT SIGNS THAT CONFLICT WITH TEMPORARY TRAFFIC CONTROLS SHALL BE COVERED COMPLETELY WITH OPAQUE MATERIAL.

**LEGEND**

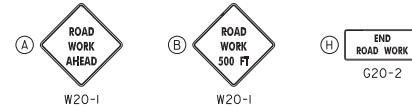

**MSK ENGINEERING AND DESIGN, INC.**  
P.O. BOX 139, 150 DEPOT STREET  
BENNINGTON, VERMONT 05201  
PH: (802) 447-1402 FAX: (802) 445-1291

**MILONE & MACBROOM**[®]  
1 South Main Street, 2nd Floor  
Waterbury, Vermont 05676  
(802) 882-8335 Fax (802) 882-8346  
www.miloneandmacbroom.com

PROJECT NAME:	KOCHER DRIVE	PLAT DATE:	10/1/2019
PROJECT NUMBER:	STP SDWK (I2) & STP BP18 (I4)	DRAWN BY:	N. YOSKOWITZ
FILE NAME:	zSPSDWK12_w2tc	CHECKED BY:	J. DOLMETSCH
PROJECT LEADER:	J. DOLMETSCH	CONSTRUCTION APPROACH SIGNING	SHEET 20 OF 29

**TRAFFIC SIGNAL NOTES**

- PROPOSED CONDUIT IN BENMONT AVE & ALDI DR. SHALL BE IN A 10' HDPE SLEEVE.
- ALL ELECTRICAL WIRING SHALL BE DONE BY A LICENSED ELECTRICIAN AND OVERSEEN BY A MASTER ELECTRICIAN.
- ALL NEW WIRING SHALL BE CONTINUOUS FROM CONTROLLER TO NEW APPARATUS.
- ALL TRAFFIC SIGNAL CONDUIT WORK SHALL BE PERFORMED IN ACCORDANCE WITH SECTION 678. ALL CONDUIT SHALL BE SCHEDULE 80 PVC.
- CUT AND AVOID DAMAGING EXISTING CONDUIT TO INSTALL JB1 AND JB2 TO PROVIDE NEW WIRING FROM THE EXISTING PP2C BACK TO THE CABINET.
- PUSHBUTTONS AND PEDESTRIAN SIGNS SHALL BE PROVIDED WITH ALL PROPOSED PEDESTRIAN SIGNALS AND SHALL COMPLY WITH VTRANS STANDARD DRAWING E-171.C. PEDESTRIAN PUSH BUTTON SHALL BE LOCATED WITHIN 10' OF SIDEWALK. PUSH BUTTONS SHALL BE INSTALLED PARALLEL TO THE CROSSWALK SERVED.
- PEDESTAL POST AND PEDESTRIAN PUSH BUTTON LOCATIONS SHALL COMPLY WITH VTRANS STANDARD DRAWING E-171.C. PEDESTRIAN PUSH BUTTON SHALL BE LOCATED WITHIN 10' OF SIDEWALK. PUSH BUTTONS SHALL BE INSTALLED PARALLEL TO THE CROSSWALK SERVED.
- CONTRACTOR TO ADJUST VIDEO DETECTION ZONE FOR RELOCATED STOP BAR FOR THE ALDI/CVS DRIVEWAY.
- SIGNAL UNDER CONSTRUCTION SIGN PANELS SHALL BE MOUNTED UNDER "ROAD CONSTRUCTION AHEAD" SIGNS ANYTIME SIGNAL SYSTEM WORK IS BEING DONE. SEE DETAIL THIS SHEET.
- A WORKING SIGNAL SYSTEM SHALL BE IN PLACE AT THE END OF EACH DAY. IF THE SIGNAL SYSTEM IS NOT IN WORKING ORDER AT END OF DAY, THE CONTRACTOR SHALL PROVIDE UNIFORMED OFFICERS TO CONTROL TRAFFIC UNTIL THE SIGNAL IS IN WORKING ORDER AT NO ADDITIONAL COST.
- CONTRACTOR TO MODIFY CONTROLLER FOUNDATION TO ACCEPT NEW CONDUIT.
- CONTRACTOR TO MODIFY CONTROLLER TO ADD CONCURRENT PEDESTRIAN PHASE TO SIGNAL TIMING.
- CONTRACTOR TO INSTALL NEW PEDESTRIAN PUSH BUTTONS (PPB) AND TOP-MOUNTED ACCESSIBLE PEDESTRIAN SIGNALS ONTO NEW PEDESTAL POSTS AS SHOWN.
- CONTRACTOR TO ADJUST VIDEO DETECTION ZONES FOR NEW LANE ARRANGEMENT. CONTRACTOR TO MODIFY CONTROLLER TO ACCOMMODATE THIS CHANGE. ALL ADJUSTMENTS SHALL BE COORDINATED WITH THE VTRANS SIGNAL ENGINEER.
- EXISTING SIGNAL TIMINGS ARE TO REMAIN UNCHANGED.
- CONDUITS FROM JB3 TO JB4 AND FROM JB1 TO JB5 ARE TO BE INSTALLED VIA DIRECTIONAL DRILL.

**ELECTRICAL CONDUIT SLEEVE**

(10' HDPE)  
 JB1 TO JB5 - 45'  
 JB3 TO JB4 - 71'

**2" ELECTRICAL CONDUIT (PVC)**

JB1 TO JB5 - 66'  
 JB3 TO JB4 - 79'

**WIRED CONDUIT**

(2" PVC)  
 CONTROLLER TO JB4 - 18'  
 JB3 TO JB2 - 30'  
 JB1 TO PP2A - 18'  
 JB1 TO PP2B - 17'  
 JB1 TO PP2C - 10'  
 JB2 TO PP2D - 6'  
 JB1 TO JB5 - 66'  
 JB3 TO JB4 - 79'

**ELECTRICAL WIRING**

JB1 TO PP2C - 27'  
 JB2 TO JB1 - 340'

LOCAL PROGRAMMING	CONTROLLER TIMING CHART							
	PHASE							
	1	2	3	4	5	6	7	8
MINIMUM GREEN		9		5	5	9		5
EXTENSION		2		2	2	2		2
YELLOW CLEARANCE		4.1		4.1	4.1	4.1		4.1
ALL RED CLEARANCE		2.7		1.6	2.7	2.7		1.6
MAX GREEN I		42		31	7	28		31
MAX GREEN II		40		27	8	25		27
MAX GREEN III		43		30	5	31		30
WALK		4		4		4		4
FLASHING DON'T WALK		11		12		11		12
RECALL		MAX				MAX		
MEMORY				N/L	L			N/L

**PROPOSED SIGNAL FACE ARRANGEMENTS**



**EXISTING SIGNAL FACE ARRANGEMENTS**

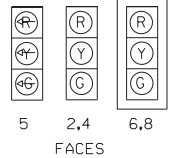

NOTE: THIS PLAN IS SHOWN FOR THE CONCURRENT PEDESTRIAN PHASE ADDED AND PEDESTRIAN HEAD LOCATIONS. EXISTING TRAFFIC SIGNAL EQUIPMENT LOCATIONS ARE APPROXIMATE.

**CONSTRUCTION SIGN DETAIL**

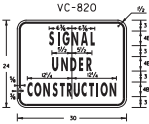

MATERIALS: SEE STD. E-146  
 COLORS: TEXT & BORDER BLACK  
 BACKGROUND - GRANGE (REFL. ENCAPSULATED LENS)

**PHASING DIAGRAM**

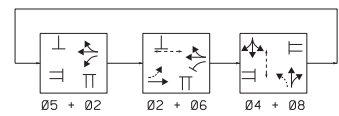

EXISTING	NEW	LEGEND
⊙	○	STRAIN POLE
⊠	⊠	CONTROLLER CABINET
⊠	⊠	PULLBOX/JUNCTION BOX
⊠	⊠	SIGNAL HEAD
---	---	CONDUIT
⊠	⊠	VIDEO DETECTION ZONES
⊠	⊠	PEDESTAL POST

EQUIPMENT	ITEM NO.	UNIT	VT ROUTE 7A & BENMONT AVE	NOTES
ELECTRICAL CONDUIT	678.21	LF	145	2" PVC
WIRED CONDUIT	678.23	LF	244	2" PVC
ELECTRICAL WIRING	678.24	LF	367	-
JUNCTION BOX	678.26	EA	5	-
HORIZONTAL DIRECTIONAL DRILLING	900.640	LF	116	10' HDPE CONDUIT SLEEVE

DUAL CYCLE SPLIT LENGTH	PHASES	OFFSETS								
	1	2	3	4	5	6	7	8	SEC	%
1-1	86	49	37	14	35	37	0	0		
2-1	80	47	33	15	32	33	0	0		
3-1	86	50	36	12	38	36	0	0		

PHASE	OPERATING TIMES
1-1	WEEKDAYS - 0900 TO 1400, 1900 TO 2300
2-1	WEEKDAYS - 0600 TO 0900
3-1	WEEKDAYS - 1400 TO 1900
2-1	SAT. & SUN. - 1000 TO 1800
1-1	SAT. & SUN. - 0600 TO 1000, 1800 TO 2300

FOR ALL OTHER TIMES, THE INTERSECTION SHALL OPERATE IN FREE MODE.



**MSK ENGINEERING AND DESIGN, INC.**  
 P.O. BOX 139, 150 DEPOT STREET  
 BENNINGTON, VERMONT 05201  
 PH: (802) 447-1402 FAX: (802) 445-1291

**MILONE & MACBROOM**  
 1 South Main Street, 2nd Floor  
 Waterbury, Vermont 05676  
 (802) 882-8335 Fax (802) 882-8346  
 www.miloneandmacbroom.com

PROJECT NAME: KOCHER DRIVE  
 PROJECT NUMBER: STP SDWK (I2) & STP BP18 (I4)  
 FILE NAME: zSTPSDWK12.fs  
 PROJECT LEADER: J. DOLMETSCH  
 DESIGNED BY: J. DOLMETSCH  
 TRAFFIC SIGNAL PLAN

PLOT DATE: 10/11/2019  
 DRAWN BY: N. YOSKOWITZ  
 CHECKED BY: J. DOLMETSCH  
 SHEET 21 OF 29

LOCAL PROGRAMMING	CONTROLLER TIMING CHART							
	PHASE							
	1	2	3	4	5	6	7	8
MINIMUM GREEN	8	8	5	8	8	8	5	8
EXTENSION	2	2	2	2	2	2	2	2
YELLOW CLEARANCE	4.8	4.8	4.1	4.1	4.8	4.8	4.1	4.1
ALL RED CLEARANCE	1.5	1.5	2.1	2.1	1.5	1.5	2.1	2.1
MAX GREEN I	13	9	9	45	8	13	8	45
MAX GREEN II	15	14	9	44	15	14	9	44
MAX GREEN III	20	9	15	47	16	13	16	46
ADVANCED PEDESTRIAN				5.0				
WALK				5.0				
FLASHING DON'T WALK				35				
RECALL								
MEMORY	L	L	L	L	L	L	L	L

EQUIPMENT	ITEM NO.	UNIT	VT ROUTE 7A / U.S. ROUTE 7	NOTES
ELECTRICAL CONDUIT	678.21	LF	225	2" PVC
WIRED CONDUIT	678.23	LF	275	2" PVC
JUNCTION BOX	678.26	EA	3	-
HORIZONTAL DIRECTIONAL DRILLING	900.640	LF	225	10" HDPE CONDUIT SLEEVE

**ELECTRICAL CONDUIT SLEEVE (10" HDPE)**  
 JB1 TO JB2 - 103'  
 JB1 TO JB3 - 122'

**2" ELECTRICAL CONDUIT (PVC)**  
 JB1 TO JB2 - 103'  
 JB1 TO JB3 - 122'

**WIRED CONDUIT (2" PVC)**  
 JB1 TO JB2 - 103'  
 JB1 TO JB3 - 122'  
 JB1 TO PP1A - 6'  
 CONTROLLER TO JB2 - 30'  
 JB3 TO PP1B - 8'

**CONSTRUCTION SIGN DETAIL**

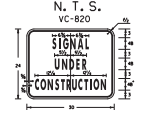

THIS INTERSECTION SHALL OPERATE IN FREE MODE.

**TRAFFIC SIGNAL NOTES**

- PROPOSED CONDUIT IN ROUTES 7 & 7A SHALL BE IN A 10" HDPE SLEEVE AND SHALL BE INSTALLED BY DIRECTIONAL BORING.
- ALL ELECTRICAL WIRING SHALL BE DONE BY A LICENSED ELECTRICIAN AND OVERSEEN BY A MASTER ELECTRICIAN.
- ALL NEW WIRING SHALL BE CONTINUOUS FROM CONTROLLER TO NEW APPARATUS.
- ALL TRAFFIC SIGNAL CONDUIT WORK SHALL BE PERFORMED IN ACCORDANCE WITH SECTION 678. ALL CONDUIT SHALL BE SCHEDULE 80 PVC.
- ADJUST VIDEO DETECTION ZONES FOR THE NEW SOUTHBOUND LEG LANE ARRANGEMENT. VIDEO DETECTION ZONES SHOWN ON THIS PLAN ARE FOR ILLUSTRATION ONLY, FIELD ADJUSTMENTS ARE REQUIRED.
- PULLBOXES / JUNCTION BOXES ARE DETAILED ON STD E-173 AND SHALL CONTAIN THE LOGO "TRAFFIC SIGNAL".
- PUSHBUTTONS AND PEDESTRIAN SIGNS SHALL BE PROVIDED WITH ALL PROPOSED PEDESTRIAN SIGNALS AND SHALL COMPLY WITH VTRANS STANDARD SPECIFICATIONS 752.13 & 752.14. PEDESTRIAN SIGN SHALL BE MUTCD STANDARD R10-3E, INSTALLED IMMEDIATELY ABOVE THE PUSH BUTTON.
- PEDESTAL POST AND PEDESTRIAN PUSH BUTTON LOCATIONS SHALL COMPLY WITH VTRANS STANDARD DRAWING E-171C. PEDESTRIAN PUSH BUTTON SHALL BE LOCATED WITHIN 10' OF SIDEWALK. PUSH BUTTONS SHALL BE INSTALLED PARALLEL TO THE CROSSWALK SERVED.
- SIGNAL UNDER CONSTRUCTION SIGN PANELS SHALL BE MOUNTED UNDER "ROAD CONSTRUCTION AHEAD" SIGNS ANYTIME SIGNAL SYSTEM WORK IS BEING DONE. SEE DETAIL THIS SHEET.
- A WORKING SIGNAL SYSTEM SHALL BE IN PLACE AT THE END OF EACH DAY, IF THE SIGNAL SYSTEM IS NOT IN WORKING ORDER AT END OF DAY, THE CONTRACTOR SHALL PROVIDE UNIFORMED OFFICERS TO CONTROL TRAFFIC UNTIL THE SIGNAL IS IN WORKING ORDER AT NO ADDITIONAL COST.
- CONTRACTOR TO MODIFY CONTROLLER FOUNDATION TO ACCEPT NEW CONDUIT.
- CONTRACTOR TO MODIFY CONTROLLER TO ADD CONCURRENT PEDESTRIAN PHASE TO SIGNAL TIMING.
- CONTRACTOR TO INSTALL NEW PEDESTRIAN PUSH BUTTONS (PPB) AND TOP-MOUNTED ACCESSIBLE PEDESTRIAN SIGNALS ONTO NEW PEDESTAL POSTS AS SHOWN.
- CONTRACTOR TO ADJUST VIDEO DETECTION ZONES FOR NEW LANE ARRANGEMENT. CONTRACTOR TO MODIFY CONTROLLER TO ACCOMMODATE THIS CHANGE. ALL ADJUSTMENTS SHALL BE COORDINATED WITH THE VTRANS SIGNAL ENGINEER.
- EXISTING SIGNAL TIMINGS ARE TO REMAIN UNCHANGED.
- CONDUITS FROM JB1 TO JB2 AND FROM JB1 TO JB3 ARE TO BE INSTALLED VIA DIRECTIONAL DRILL.

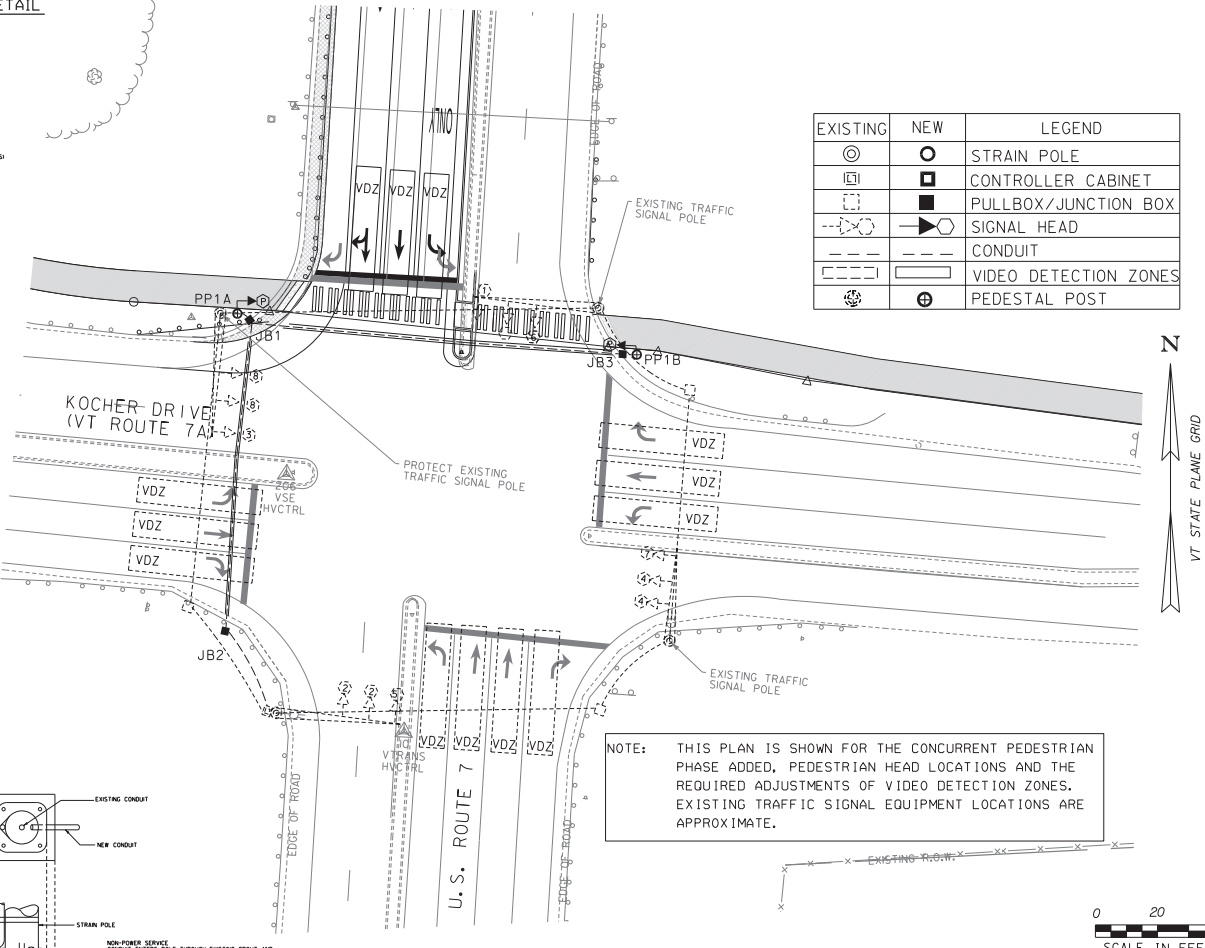

NOTE: THIS PLAN IS SHOWN FOR THE CONCURRENT PEDESTRIAN PHASE ADDED, PEDESTRIAN HEAD LOCATIONS AND THE REQUIRED ADJUSTMENTS OF VIDEO DETECTION ZONES. EXISTING TRAFFIC SIGNAL EQUIPMENT LOCATIONS ARE APPROXIMATE.

**EXISTING SIGNAL FACE ARRANGEMENTS**

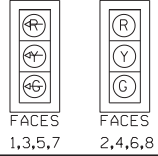

**PROPOSED SIGNAL FACE ARRANGEMENTS**

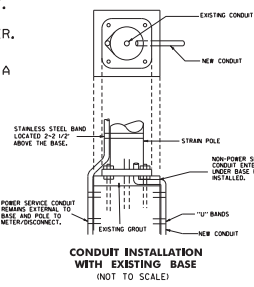

<b>MSK ENGINEERING AND DESIGN, INC.</b> P.O. BOX 139, 150 DEPOT STREET BENNINGTON, VERMONT 05201 PH: (802) 447-1402 FAX: (802) 445-1291	<b>MILONE &amp; MACBROOM</b> 1 South Main Street, 2nd Floor Waterbury, Vermont 05676 (802) 882-8335 Fax (802) 882-8346 www.miloneandmacbroom.com	PROJECT NAME: KOCHER DRIVE	PROJECT NUMBER: STP SDWK (I2) & STP BP18 (I4)
		FILE NAME: zSTPSDWK12.fs	PLOT DATE: 10/11/2019
PROJECT LEADER: J. DOLMETSCH	DRAWN BY: N. YOSKOWITZ	DESIGNED BY: J. DOLMETSCH	CHECKED BY: J. DOLMETSCH
SIGNAL PLAN	SHEET 22 OF 29		

# P3-5

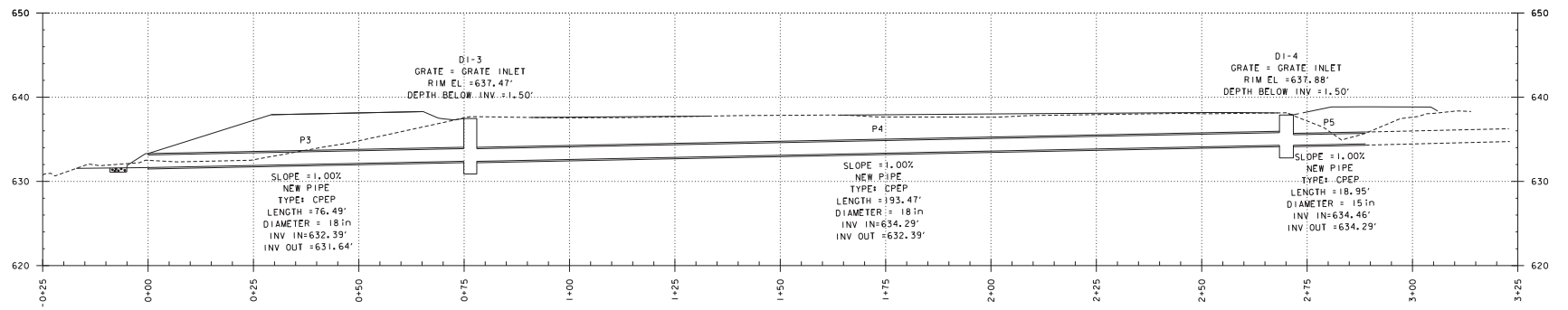

LINE	SURFACE	OFFSET
-----	Kocher_Combined	0.00
-----	Scaled	3.0000 Times Ver.
-----	Scaled	1.5000 Times Hor.



**MSK ENGINEERING AND DESIGN, INC.**  
 P.O. BOX 139, 150 DEPOT STREET  
 BENNINGTON, VERMONT 05201  
 PH: (802) 447-1402 FAX: (802) 445-1291

**MILONE & MACBROOM**  
 1 South Main Street, 2nd Floor  
 Waterbury, Vermont 05676  
 (802) 882-8335 Fax (802) 882-8346  
 www.miloneandmacbroom.com

PROJECT NAME: KOCHER DRIVE  
 PROJECT NUMBER: STP SDWK (I2) & STP BP18 (I4)  
 FILE NAME: zSTPSDWK12.drn  
 PROJECT LEADER: J. DOLMETSCH  
 DESIGNED BY: J. DOLMETSCH  
 DRAINAGE PROFILES

PLOT DATE: 10/1/2019  
 DRAWN BY: N. YOSKOWITZ  
 CHECKED BY: J. DOLMETSCH  
 SHEET 23 OF 29



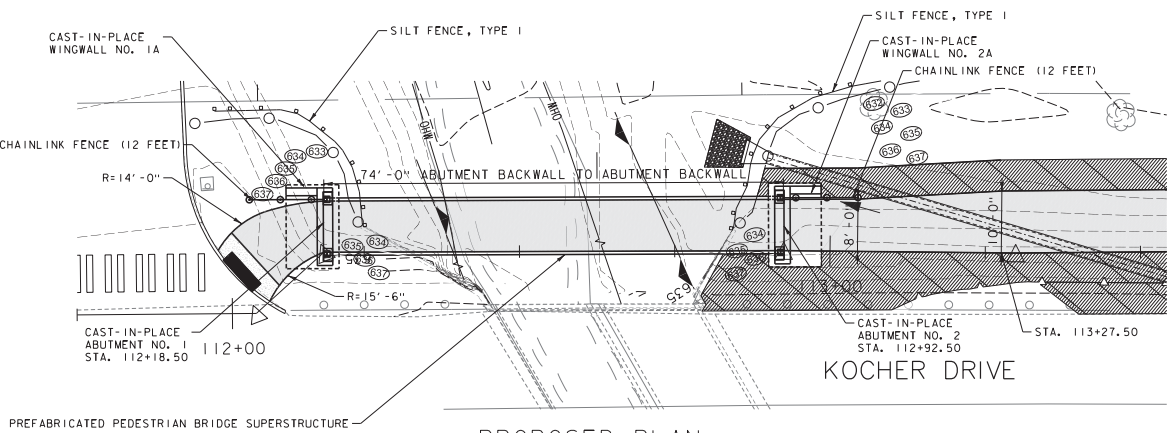

**PROPOSED PLAN**  
 SCALE: 1"=10'-0"

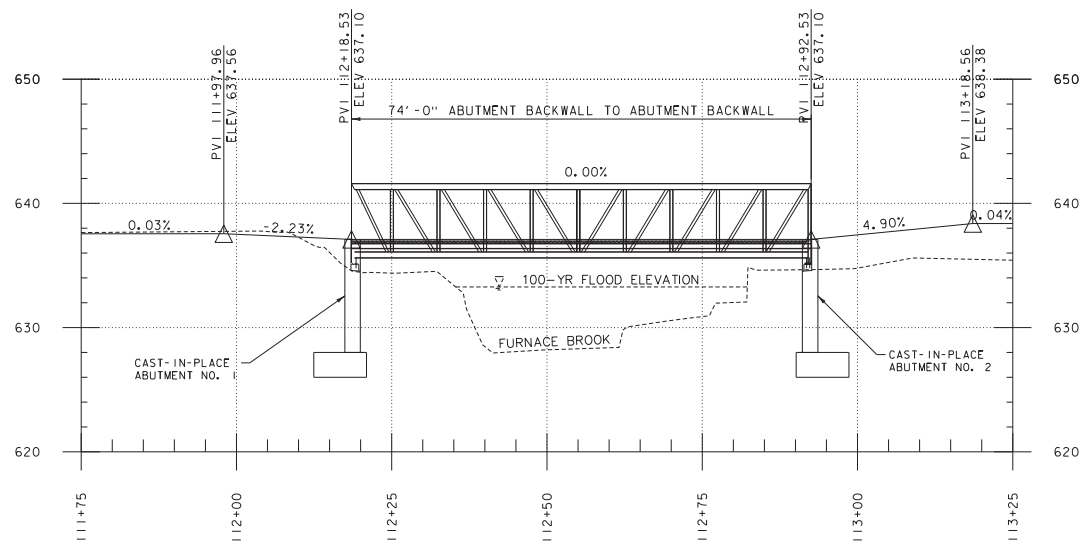

**PROPOSED ELEVATION**  
 SCALE: 1"=10'-0"

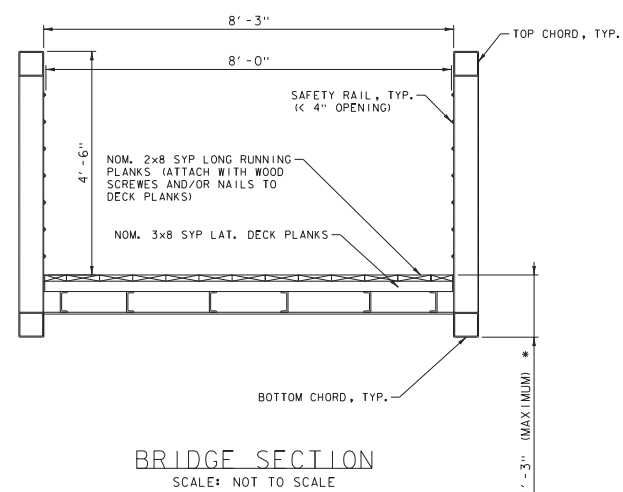

NOTE:  
 * - TOP OF DECK TO BOTTOM OF LOW CHORD SHALL NOT EXCEED 1'-3"

LINE	SURFACE	OFFSET
-----	Existing	0.00
Scaled	2,000 Times Ver.	
Scaled	1,000 Times Hor.	

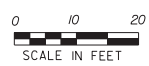

**MSK ENGINEERING AND DESIGN, INC.**  
 P.O. BOX 139, 150 DEPOT STREET  
 BENNINGTON, VERMONT 05201  
 PH: (802) 447-1402 FAX: (802) 445-1291

**MILONE & MACBROOM®**  
 1 South Main Street, 2nd Floor  
 Waterbury, Vermont 05676  
 (802) 882-8335 Fax (802) 882-8346  
 www.miloneandmacbroom.com

PROJECT NAME: KOCHER DRIVE  
 PROJECT NUMBER: STP SDWK (I2) & STP BP18 (I4)  
 FILE NAME: zSTPSDWK12_STRPLN.dgn  
 PROJECT LEADER: J. DOLMETSCH  
 DESIGNED BY: J. DOLMETSCH  
 BRIDGE PLANS AND DETAILS  
 PLOT DATE: 10/1/2019  
 DRAWN BY: N. YOSKOWITZ  
 CHECKED BY: J. DOLMETSCH  
 SHEET 24 OF 29

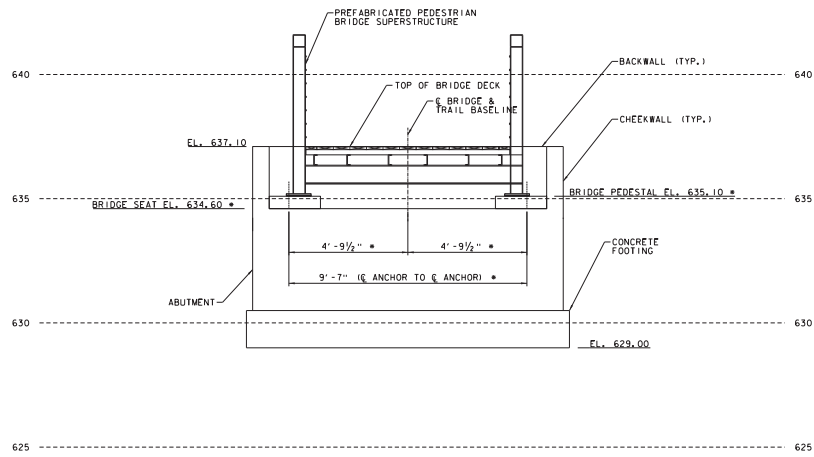

TYPICAL ABUTMENT ELEVATION  
SCALE: 1/2" = 1' - 0"

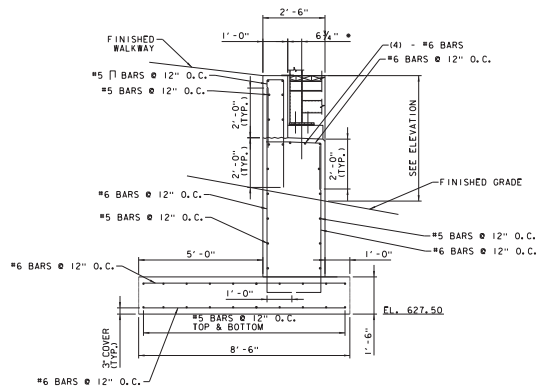

TYPICAL ABUTMENT SECTION  
SCALE: 1/2" = 1' - 0"

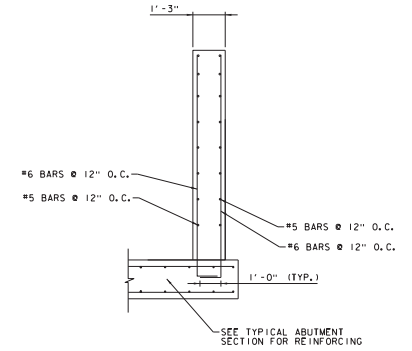

TYPICAL WINGWALL SECTION  
SCALE: 1/2" = 1' - 0"

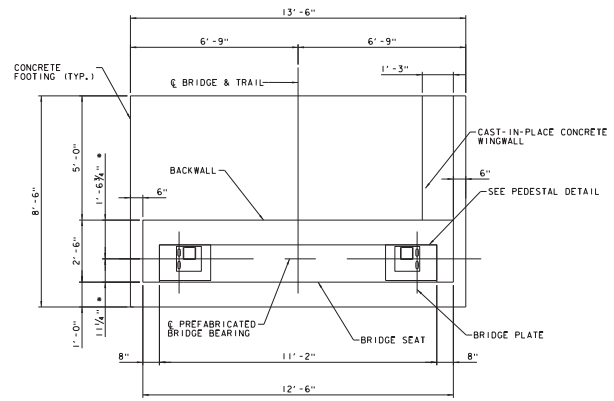

TYPICAL ABUTMENT PLAN  
SCALE: 1/2" = 1' - 0"

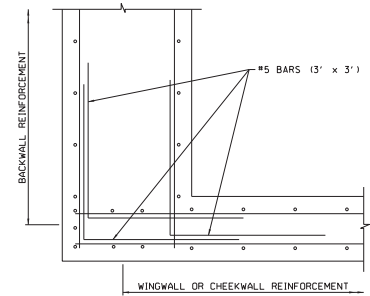

TYPICAL ABUTMENT PEDESTAL REINFORCING  
SCALE: 1/4" = 1' - 0"

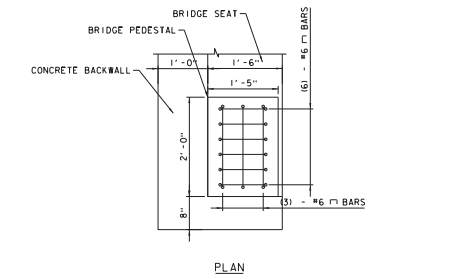

PLAN

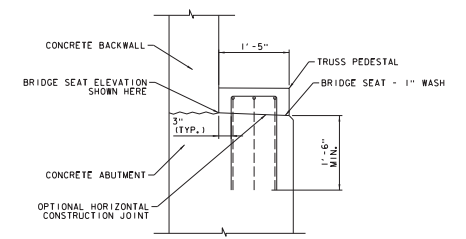

SECTION

TYPICAL ABUTMENT PEDESTAL REINFORCING  
SCALE: 1/4" = 1' - 0"

NOTES  
 * DIMENSION SHALL BE UPDATED DURING  
 PREFABRICATED PEDESTRIAN BRIDGE SUPERSTRUCTURE  
 SHOP DRAWING REVIEW



**MSK ENGINEERING AND DESIGN, INC.**  
 P.O. BOX 139, 150 DEPOT STREET  
 BENNINGTON, VERMONT 05201  
 PH: (802) 447-1402 FAX: (802) 445-1291

**MILONE & MacBROOM®**  
 1 South Main Street, 2nd Floor  
 Waterbury, Vermont 05676  
 (802) 882-8335 Fax (802) 882-8346  
 www.miloneandmacbroom.com

PROJECT NAME: KOCHER DRIVE	PLOT DATE: 10/1/2019
PROJECT NUMBER: STP SDWK (I2) & STP BP18 (I4)	DRAWN BY: N. YOSKOWITZ
FILE NAME: zSTPSDWK12_STRDET.dgn	CHECKED BY: J. DOLMETSCH
PROJECT LEADER: J. DOLMETSCH	SHEET 25 OF 29
DESIGNED BY: J. DOLMETSCH	
BRIDGE PLANS AND DETAILS	

**GENERAL STRUCTURAL NOTES**

1. ALL MATERIALS AND CONSTRUCTION SHALL CONFORM TO STATE OF VERMONT, AGENCY OF TRANSPORTATION, 2018 STANDARD SPECIFICATIONS FOR CONSTRUCTION, AND ITS LATEST REVISIONS, AND THE AASHTO LRFD BRIDGE SPECIFICATIONS, 8TH EDITION 2017, AND ITS LATEST REVISIONS.
2. BRIDGE DESIGN SHALL CONFORM TO STATE OF VERMONT, AGENCY OF TRANSPORTATION, 2010 STRUCTURES DESIGN MANUAL, AND AASHTO STANDARD SPECIFICATION ALLOWABLE STRESS DESIGN (ASD).
3. THE PRE-FABRICATED BRIDGE SHALL BE DESIGNED FOR MAXIMUM PEDESTRIAN LIVE LOAD OF 90 PSF.
4. ALL WORK AND ANY ASSOCIATED ACTIVITY ON THIS PROJECT SHALL BE PERFORMED WITHIN THE EXISTING RIGHT-OF-WAY LIMITS AS SHOWN IN THE REFERENCE PLANS.
5. ALL DIMENSIONS ARE HORIZONTAL OR VERTICAL AND ARE GIVEN AT 68 DEGREES FAHRENHEIT UNLESS OTHERWISE NOTED.
6. DIMENSIONS OF THE EXISTING STRUCTURE SHOWN ON THESE PLANS ARE FOR GENERAL REFERENCE ONLY. THEY HAVE BEEN TAKEN FROM THE ORIGINAL DRAWINGS AND FIELD MEASUREMENTS. THE CONTRACTOR SHALL TAKE ALL FIELD MEASUREMENTS NECESSARY TO ASSURE PROPER FIT OF THE FINISHED WORK AND SHALL ASSUME FULL RESPONSIBILITY FOR THEIR ACCURACY.

**STRUCTURAL STEEL**

1. SITE CONDITIONS AND GEOMETRY OF THE BRIDGE MAY CONTRIBUTE TO DIFFICULTIES IN ERECTING THE PRE-FABRICATED BRIDGE. THE CONTRACTOR IS REQUIRED TO VISIT THE SITE PRIOR TO BIDDING TO DETERMINE ANY COMPLICATIONS THAT MAY ARISE WHEN SETTING THE BRIDGE.
2. STRUCTURAL STEEL (LOW ALLOY) SHALL CONFORM TO AASHTO M270, GRADE 50.
3. ANY CONNECTIONS THAT ARE NOT DETAILED ON THE PLANS SHALL BE DETAILED BY THE FABRICATOR AND SUBMITTED TO THE STRUCTURES ENGINEER FOR APPROVAL.
4. ALL WELDING SHALL CONFORM TO THE PROVISIONS OF SUBSECTION 506.10.
5. ENDS OF BEAMS SHALL BE VERTICAL AFTER THE APPLICATION OF FULL DEAD LOAD.

**HIGH STRENGTH BOLTS**

1. UNLESS NOTED OTHERWISE, ALL FASTENERS SHALL BE ASTM A325 HIGH-STRENGTH BOLTS (GALVANIZED). THE NUTS SHALL BE ASTM A563 AND WASHERS SHALL BE ASTM F436.
2. ALL BOLT HOLES SHALL BE STANDARD-SIZED UNLESS OTHERWISE NOTED.

**ERECTION**

1. THE CONTRACTOR SHALL TAKE THE PROPER PRECAUTIONS TO ENSURE THE STABILITY OF ALL STRUCTURAL ELEMENTS UNTIL THE TOTAL STRUCTURE IS SELF SUPPORTING.

**STRUCTURAL SUBMITTALS**

1. REINFORCING STEEL SHOP DRAWINGS
2. PREFABRICATED PEDESTRIAN BRIDGE SUPERSTRUCTURE SHOP DRAWINGS AND CALCULATIONS
3. FENCE SHOP DRAWINGS

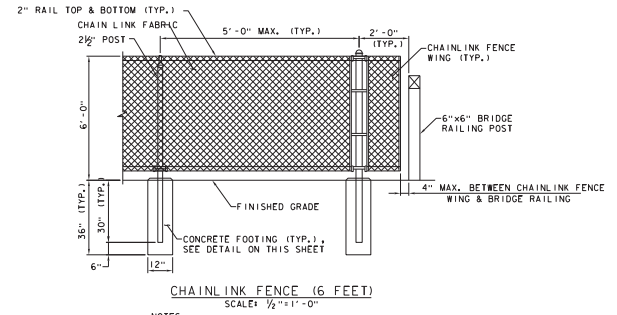
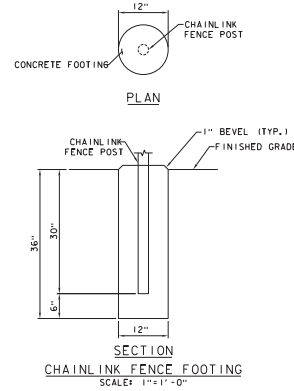

**NOTES**

1. CONTRACTOR SHALL SUBMIT SHOP DRAWINGS FOR APPROVAL PRIOR TO FABRICATION.
2. ALL FENCE HARDWARE & CHAIN LINK FABRIC SHALL BE PAINTED TO COLOR BLACK.
3. NO SEPARATE PAYMENT FOR CHAIN LINK FENCE FOOTING AND CHAIN LINK FENCE WING.

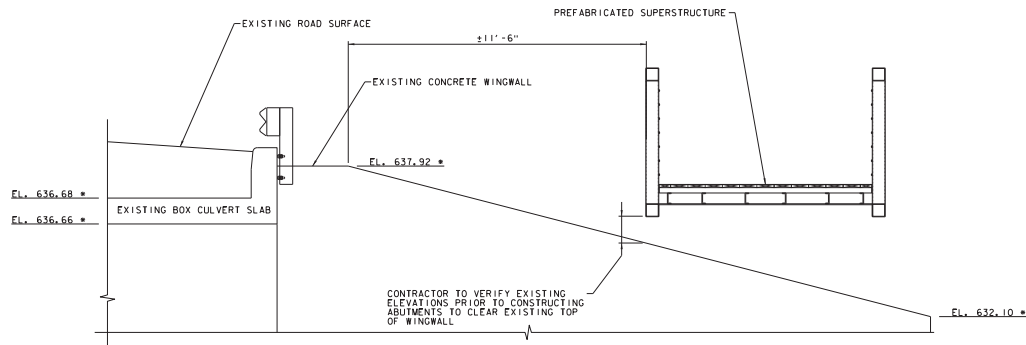

**EXISTING WESTERN WINGWALL**  
SCALE: 1/2"=1'-0"

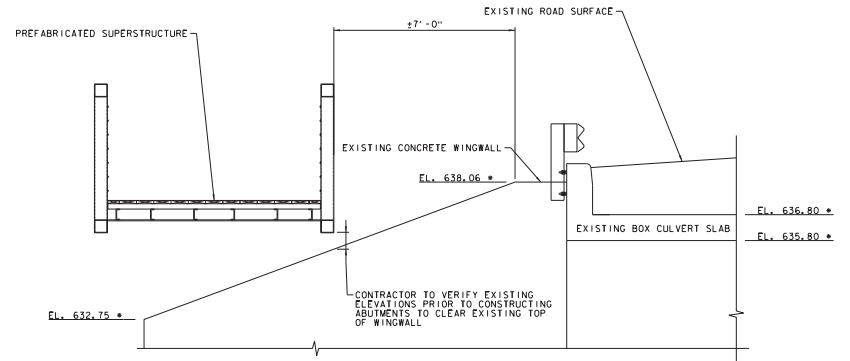

**EXISTING EASTERN WINGWALL**  
SCALE: 1/2"=1'-0"

* EXISTING ELEVATIONS SHALL BE CONFIRMED IN THE FIELD PRIOR TO CONSTRUCTION

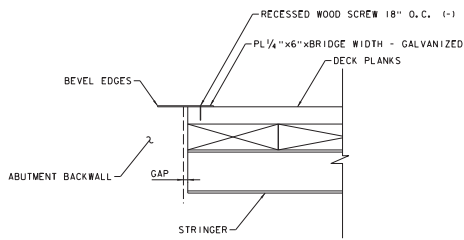

**COVER PLATE DETAIL**  
SCALE: NOT TO SCALE



**MSK ENGINEERING AND DESIGN, INC.**  
P.O. BOX 139, 150 DEPOT STREET  
BENNINGTON, VERMONT 05201  
PH: (802) 447-1402 FAX: (802) 445-1291

**MILONE & MacBROOM**  
1 South Main Street, 2nd Floor  
Waterbury, Vermont 05676  
(802) 882-8335 Fax (802) 882-8346  
www.miloneandmacbroom.com

PROJECT NAME: KOCHER DRIVE	PLOT DATE: 10/1/2019
PROJECT NUMBER: STP SDWK (I2) & STP BP18 (I4)	DRAWN BY: N. YOSKOWITZ
FILE NAME: zSTP5DWK12_STRDET.dgn	CHECKED BY: J. DOLMETSCH
PROJECT LEADER: J. DOLMETSCH	SHEET 26 OF 29
DESIGNED BY: J. DOLMETSCH	
BRIDGE PLANS AND DETAILS	



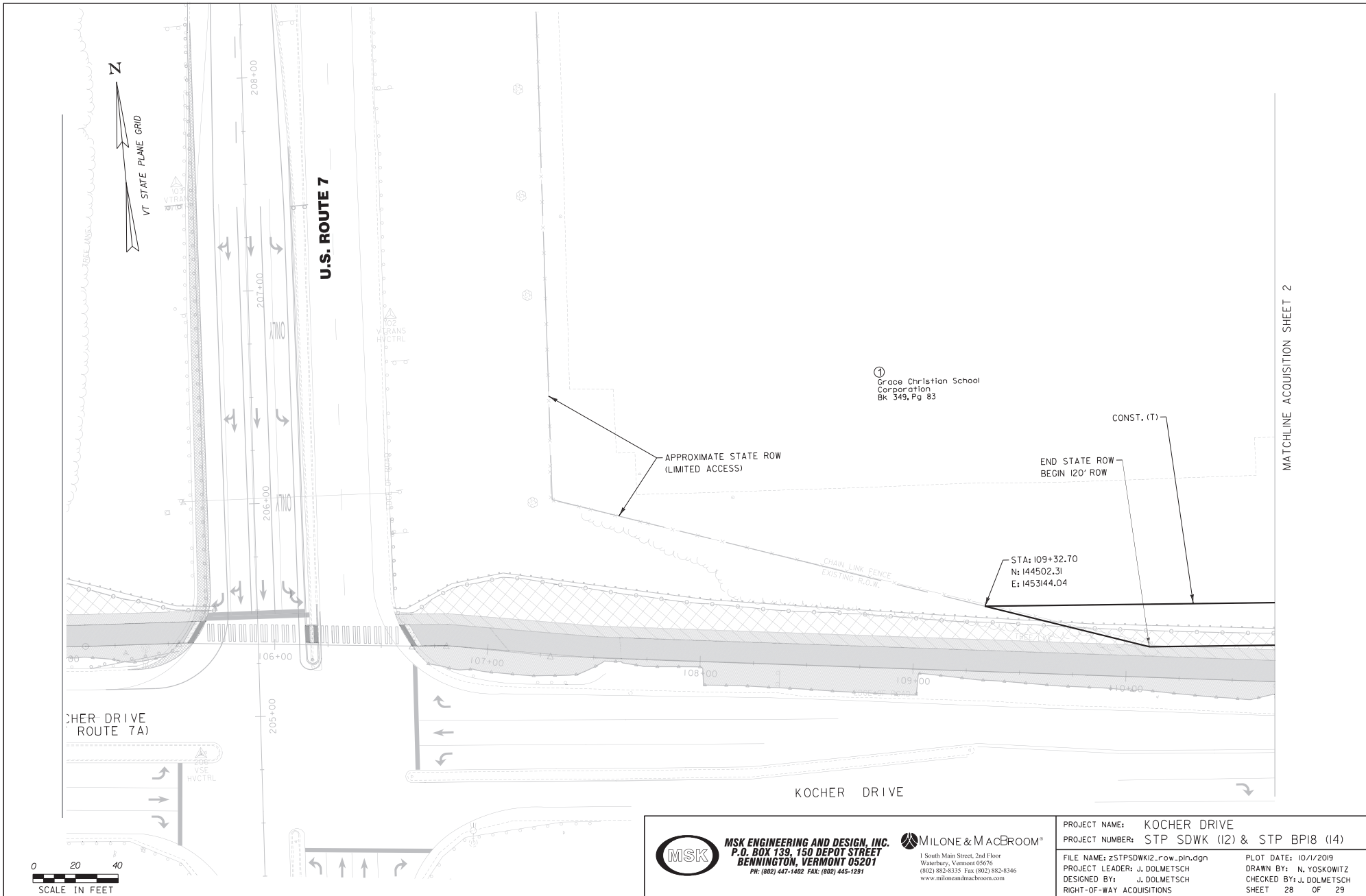

MATCHLINE ACQUISITION SHEET 2



**MSK ENGINEERING AND DESIGN, INC.**  
 P.O. BOX 139, 150 DEPOT STREET  
 BENNINGTON, VERMONT 05201  
 PH: (802) 447-1402 FAX: (802) 445-1291

**MILONE & MacBROOM***  
 1 South Main Street, 2nd Floor  
 Waterbury, Vermont 05676  
 (802) 882-8335 Fax (802) 882-8346  
 www.miloneandmacbroom.com

PROJECT NAME:	KOCHER DRIVE		
PROJECT NUMBER:	STP SDWK (I2) & STP BP18 (I4)		
FILE NAME:	zSTPSDWK12.row.pln.dgn	PLOT DATE:	10/1/2019
PROJECT LEADER:	J. DOLMETSCH	DRAWN BY:	N. YOSKOWITZ
DESIGNED BY:	J. DOLMETSCH	CHECKED BY:	J. DOLMETSCH
RIGHT-OF-WAY ACQUISITIONS		SHEET	28 OF 29

MATCHLINE ACQUISITION SHEET 1

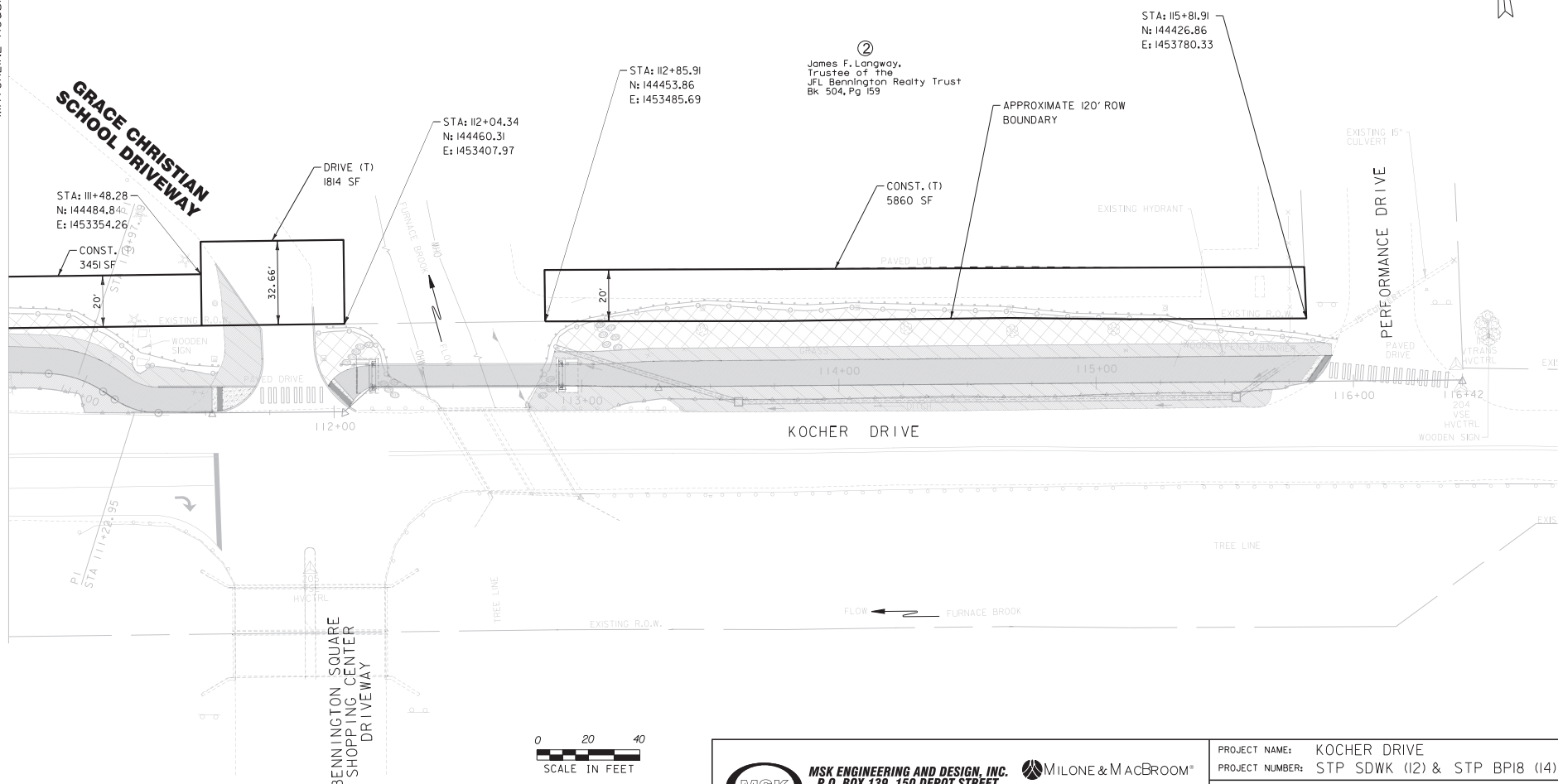

**GRACE CHRISTIAN SCHOOL DRIVEWAY**

STA: 111+48.28  
N: 144484.84  
E: 1453354.26

CONST. 3451 SF

DRIVE (T)  
1814 SF

STA: 112+04.34  
N: 144460.31  
E: 1453407.97

STA: 112+85.91  
N: 144453.86  
E: 1453485.69

②  
James F. Langway,  
Trustee of the  
JFL Bennington Realty Trust  
Bk 504, Pg 159

CONST. (T)  
5860 SF

APPROXIMATE 120' ROW  
BOUNDARY

STA: 115+81.91  
N: 144426.86  
E: 1453780.33

KOCHER DRIVE

PERFORMANCE DRIVE

BENNINGTON SQUARE  
SHOPPING CENTER  
DRIVEWAY



**MSK ENGINEERING AND DESIGN, INC.**  
P.O. BOX 139, 150 DEPOT STREET  
BENNINGTON, VERMONT 05201  
PH: (802) 447-1402 FAX: (802) 445-1291

**MILONE & MACBROOM®**  
1 South Main Street, 2nd Floor  
Waterbury, Vermont 05676  
(802) 882-8335 Fax (802) 882-8346  
www.miloneandmacbroom.com

PROJECT NAME:	KOCHER DRIVE	PLOT DATE:	10/1/2019
PROJECT NUMBER:	STP SDWK (I2) & STP BP18 (I4)	DRAWN BY:	N. YOSKOWITZ
FILE NAME:	zSTPSDWK12.row.pln.dgn	CHECKED BY:	J. DOLMETSCH
PROJECT LEADER:	J. DOLMETSCH	RIGHT-OF-WAY ACQUISITIONS	SHEET 29 OF 29